

**BID NUMBER 10319**

**SOUTHERN UNIVERSITY AND A&M COLLEGE  
BATON ROUGE CAMPUS**

**REQUEST FOR BID # 10319**

**APRIL 30, 2024 - 10:30 AM**

**TENNIS COURTS & LIGHTING**

**Installation of Three (3) ASBA Certified Tennis Courts & Lighting**

**Location: Baton Rouge Campus**

**MANDATORY PRE—BID CONFERENCE  
AND SITE VISIT:**

**APRIL 16, 2024 @ 10:30 AM**  
Physical Plant Department  
Benjamin H. Kraft Building  
515 James L. Hunt Street  
Southern University  
Baton Rouge Campus  
Site Telephone No. 225-771-4741

**DEADLINE TO SUBMIT INQUIRIES:**

**APRIL 19, 2024 by 5:00 PM**

**SUBMIT INQUIRIES TO:**

**Linda Antoine**  
Email: linda\_antoine@subr.edu

**DEADLINE TO RESPOND TO INQUIRIES APRIL 24, 2024 by 5:00 PM**

*Note: Responses to inquiries/Addenda are pasted on LaPAC (LA Procurement Website)*

*LA State Procurement website:*

*<https://wwwcfprd.doa.louisiana.gov/OSP/LaPAC/Agency/outMain.cfm>*

*It is the responsibility of the vendor to check LAPAC for addenda.*

**DEADLINE TO SUBMIT BID:**

**APRIL 30, 2024 @ 10:30 AM**

**SUBMIT BID TO:**

Linda Antoine, Director  
Southern University Purchasing  
Department-P. O. Box 9534 or  
James L. Prestage Drive  
J. S. Clark Adm. Bldg. Annex, 1<sup>st</sup>Floor  
Baton Rouge, LA 70813  
Telephone No. 225-771-2804 or 771-4587

**ADVERTISEMENT  
SOUTHERN NIVERSITY AND A&M COLLEGE  
REQUEST FOR BID**

**REQUEST FOR BID # 10319**

**APRIL 30, 2024 – 10:30 AM**

**TENNIS COURTS**

***Installation of Three (3) ASBA Certified Tennis Courts***

***Location: Baton Rouge Campus***

Sealed bids will be received by Southern University, Baton Rouge, Louisiana, in the Purchasing Office, 8100 James L. Prestage Drive, J. S. Clark Administration Building Annex, South Entrance, First Floor East. Bidders are solely responsible for ensuring timely delivery of their bids. The Southern University Purchasing Department is not responsible for any delays caused by bidders' chosen means of delivery. Failure to meet the bid deadline submittal date and time shall result in rejection of bid.

**MAIL OR HAND-DELIVER BID TO PURCHASING DEPARTMENT NO  
LATER THAN 10:30 AM-APRIL 30, 2024**

Bids are opened in the Purchasing Department.

**Mandatory Pre-Bid Conference & Site Visit: April 16, 2024 @ 10:30 am**  
**Site Visit Location: Physical Plant Department, Benjamin H. Kraft Building**  
**515 James L. Hunt Street**  
**(Southern University Campus)**  
**Baton Rouge, La 70813**  
**Site Visit Telephone Contact Numbers: 225-771-4741**

**Participants shall be in attendance by 10:30 a.m. and sign-in on sheet provided by the Purchasing Department.**

Bidders shall visit the site and be familiarized with the local conditions under which the work is to be performed. No additional compensation will be granted because of unusual difficulties, which may be encountered in the execution of any portion of the work.

Inquiries will be accepted until April 19, 2024 by 5:00 p.m. Inquiries shall be submitted to Linda Antoine at [linda\\_antoine@subr.edu](mailto:linda_antoine@subr.edu)

Responses to inquiries will be posted on LAPAC-LA State Procurement website by April 24, 2024 by 5:00 p.m.

All bids must be accompanied by bid security equal to **five (5%) percent of the sum of the base bid and all alternates, if applicable** and must be in the form of a certified/official check, cashier's check or bid bond, made payable to Southern University and A & M College. Surety represents that it is listed on the current U.S. Department of the Treasury Financial Management Service list of approved bonding companies and that is listed thereon as approved for amount equal to or greater than the amount for which it obligates itself in this instrument. No bid bond indicating an obligation of less than five percent (5%) by any method is acceptable.

The successful bidder shall be required to furnish a **Performance and Payment Bond** written by a company licensed to do business in Louisiana, in an amount equal to 100% of the contract amount and who is currently on the U.S. Department of the Treasury Financial Management Service List.

Any person requiring special accommodations should notify the Purchasing Office of the type(s) of accommodation required not less than seven (7) days before the bid opening date.

Bidders shall include the following on envelope of choice: company's name, address, Louisiana contractor's license number, bid number, bid opening date and time.

Bids may be withdrawn by written, telegraphic fax notice or email and received at the address or email address designated in the Invitation to Bid prior to the time set for bid opening, as recorded by date stamp at the Purchasing Office. Bids received after closing time will be returned unopened. Evidence of authority to submit the bid shall be required in accordance with R.S. 38:2212(a)(1)(c) and/or R.S. 39:1594(c)(2)(d).

The Southern University System is a participant in the Louisiana for the Small Entrepreneurships Program (the Hudson Initiative) and the Louisiana Initiative for Veterans and Service-Connected Disabled Veterans-Owned Business Small Entrepreneurships. Bidders are encouraged to consider participation. A list of certified vendors and additional information can be obtained from website <http://www.ledsmallbiz.com>. Potential participants may also register at this website.

***ALL BID SPECIFICATIONS CAN BE OBTAINED BY ACCESSING THE LA STATE PROCUREMENT WEBSITE***

***<https://wwwcfprd.doa.louisiana.gov/osp/lapac/pubMain.cfm>***

Any questions concerning bid documents, please contact Mary Jane Spruel, Assistant Director of Purchasing at (225) 771-2800 or (225) 771-2804 or email to [maryjane\\_spruel@subr.edu](mailto:maryjane_spruel@subr.edu)

The University reserves the right to reject all bids and to waive any informalities incidental thereto. Bids will be accepted only from contractors who are licensed under Louisiana R.S. 39:2150-2173 for the classification of: 72000000 Building and Construction, and Maintenance Services; 72101500 Building Support Services; 72131600 Commercial or Industrial Construction, Tennis Courts.

**SOUTHERN UNIVERSITY & A&M COLLEGE  
AN EQUAL OPPORTUNITY EMPLOYER**

**Linda A. Antoine, Director of Purchasing**

**DATES ADVERTISED:**

**APRIL 2, 9, & 16, 2024**

# LOUISIANA UNIFORM PUBLIC WORK BID FORM

**TO: Southern University and A&M College**  
Post Office Box 9534  
James J. Prestage Dr-J.S. Clark Adm. Bldg. Annex  
Baton Rouge, LA 70813

**BID FOR: Bid Number 10319**  
Tennis Court & Lighting  
Southern University and A&M College  
Baton Rouge Campus

The undersigned bidder hereby declares and represents that she/he: a) has carefully examined and understands the Bidding Documents, b) has not received, relied on, or based his bid on any verbal instructions contrary to the Bidding Documents or any addenda, c) has personally inspected and is familiar with the project site, and hereby proposes to provide all labor, materials, tools, appliances and facilities as required to perform, in a workmanlike manner, all work and services for the construction and completion of the referenced project, all in strict accordance with the Bidding Documents prepared by: SU Facilities Planning & Purchasing Department 3/24/2024

Bidders must acknowledge all addenda. The Bidder acknowledges receipt of the following **ADDENDA:** (Enter the number the Designer has assigned to each of the addenda that the Bidder is acknowledging) N/A

**TOTAL BASE BID:** For all work required by the Bidding Documents (including any and all unit prices designated "Base Bid" \* but not alternates) the sum of:

\_\_\_\_\_ Dollars (\$ \_\_\_\_\_)

**ALTERNATES:** For any and all work required by the Bidding Documents for Alternates including any and all unit prices designated as alternates in the unit price description.

**Alternate No. 1** (Owner to provide description of alternate and state whether add or deduct) for the lump sum of: \_\_\_\_\_ Dollars (\$ \_\_\_\_\_)

**Alternate No. 2** (Owner to provide description of alternate and state whether add or deduct) for the lump sum of: \_\_\_\_\_ Dollars (\$ \_\_\_\_\_)

**Alternate No. 3** (Owner to provide description of alternate and state whether add or deduct) for the lump sum of: \_\_\_\_\_ Dollars (\$ \_\_\_\_\_)

**NAME OF BIDDER:** \_\_\_\_\_

**ADDRESS OF BIDDER:** \_\_\_\_\_

**EMAIL:** \_\_\_\_\_

**PHONE:** \_\_\_\_\_

**LOUISIANA CONTRACTOR'S LICENSE NUMBER:** \_\_\_\_\_

**PRINT NAME OF AUTHORIZED SIGNATORY OF BIDDER:** \_\_\_\_\_

**TITLE OF AUTHORIZED SIGNATORY OF BIDDER:** \_\_\_\_\_

**SIGNATURE OF AUTHORIZED SIGNATORY OF BIDDER:** \_\_\_\_\_

**DATE:** \_\_\_\_\_

Completion Time: \_\_\_\_\_ consecutive calendar days, or within the time that may be extended as stipulated in the contract.

Liquidated Damages: **\$150 per day.**

**5% Bid Security: XX YES** (shall be included with bid)

(check here) \_\_\_\_\_ **Bid Security included. Bid Security shall be total of 5% for base bid and alternates.**

Successful bidder will be notified by letter to secure Performance and Payment Bond up to 100% of cost.

(check here) \_\_\_\_\_ **Board Resolution included or Secretary of State Registration**

**A CORPORATE RESOLUTION OR WRITTEN EVIDENCE** of the authority of the person signing the bid for the public work as prescribed by LA R.S. 38:2212(B)(5) or Secretary of State verification.

**BID SECURITY** in the form of a bid bond, certified check or cashier's check as prescribed by LA RS 38:2218.A is attached to and made a part of this bid.

The Unit Price Form shall be used if the contract includes unit prices. *Otherwise it is not required and need not be included with the form.* The number of unit prices that may be included is not limited and additional sheets may be included if needed.

# LOUISIANA UNIFORM PUBLIC WORK BID FORM

## UNIT PRICE FORM

BID FOR: Bid Number 10319

TO: Southern University and A&M College

Post Office Box 9534

James J. Prestage Dr.-J. S. Clark Administration Bldg. Annex

Baton Rouge, LA 70813

### TENNIS COURT INSTALLATION & LIGHTING

**UNIT PRICES:** This form shall be used for any and all work required by the Bidding Documents and described as unit prices. Amounts shall be stated in figures and only in figures.

DESCRIPTION:	<input type="checkbox"/> Base Bid or <input type="checkbox"/> Alt.# _____				
REF. NO.	QUANTITY:	UNIT OF MEASURE:	UNIT PRICE	UNIT PRICE EXTENSION (Quantity times Unit Price)	
DESCRIPTION:	<input type="checkbox"/> Base Bid or <input type="checkbox"/> Alt.# _____				
REF. NO.	QUANTITY:	UNIT OF MEASURE:	UNIT PRICE	UNIT PRICE EXTENSION (Quantity times Unit Price)	
DESCRIPTION:	<input type="checkbox"/> Base Bid or <input type="checkbox"/> Alt.# _____				
REF. NO.	QUANTITY:	UNIT OF MEASURE:	UNIT PRICE	UNIT PRICE EXTENSION (Quantity times Unit Price)	
DESCRIPTION:	<input type="checkbox"/> Base Bid or <input type="checkbox"/> Alt.# _____				
REF. NO.	QUANTITY:	UNIT OF MEASURE:	UNIT PRICE	UNIT PRICE EXTENSION (Quantity times Unit Price)	
DESCRIPTION:	<input type="checkbox"/> Base Bid or <input type="checkbox"/> Alt.# _____				
REF. NO.	QUANTITY:	UNIT OF MEASURE:	UNIT PRICE	UNIT PRICE EXTENSION (Quantity times Unit Price)	
DESCRIPTION:	<input type="checkbox"/> Base Bid or <input type="checkbox"/> Alt.# _____				
REF. NO.	QUANTITY:	UNIT OF MEASURE:	UNIT PRICE	UNIT PRICE EXTENSION (Quantity times Unit Price)	

**Wording for "DESCRIPTION" is to be provided by the Owner.**  
**All quantities are estimated. The contractor will be paid based upon actual quantities as verified by the Owner.**

**SOUTHERN UNIVERSITY AND A&M COLLEGE  
BATON ROUGE CAMPUS  
REQUEST FOR BID**

**PROJECT: TENNIS COURTS & LIGHTING**  
**LOCATION: SU BATON ROUGE CAMPUS**  
**BID DUE DATE: APRIL 30, 2024 @ 10:30 AM**  
**BID # 10319**

Bids submitted are subject to provisions of but not limited to La.R.S.38 Purchasing Rules and Regulations; Executive Orders; and the General Terms and Conditions, listed in this Invitation for Bid. Southern University reserves the right to award items separately, grouped or on an all or none basis and to reject any or all bids and waive any informalities.

**BIDS MAY BE SENT BY MAIL OR HAND-DELIVERED TO:**

**Bids should be mailed to:**  
Southern University  
Purchasing Department  
Post Office Box 9534  
Baton Rouge, Louisiana 70813

**As an alternative, bids may be hand delivered to:**  
Southern University  
Purchasing Department  
1<sup>st</sup> Floor East-James L. Prestage Drive  
J. S. Clark Administration Building  
Baton Rouge, Louisiana 70813

**MANDATORY PRE-BID CONFERENCE & SITE VISIT: APRIL 16, 2024 @ 10:30AM**

**INQUIRIES:**

No negotiations, decisions, or actions will be executed by any bidder as a result or any oral discussion with any University employee or State Consultant. Only those transactions which are in writing, sent to **Linda A. Antoine, Director of Purchasing, will be considered as valid.**

**INSTRUCTIONS TO BIDDERS**

**1. Bid Forms**

All written bids, unless otherwise provided for, must be submitted on, and in accordance with forms provided and properly signed in ink. Bids submitted in the following manner will not be accepted:

Bid containing no signature indicating intent to be bound

(1) Bid filled out in pencil

(2) Bid not submitted on University standard forms

Bids must be received at the address specified in the Invitation for Bid prior to bid opening time in order to be considered. .

**2. Envelope (if mailed)**

Bidders are requested to submit bid package in a sealed envelope of your choice that is clearly marked identifying the *company's name, complete address, bid number, time and date of bid opening, and license number, if applicable.*

Bidder is responsible for means of delivery of bid.

**Louisiana Contractors License Number shall be placed on the outside of the envelope.**

**3. Standards of Quality**

Any product or service bid shall conform to all applicable federal, state and local laws, regulations and the specifications contained in the IFB. Unless otherwise specified in the IFB, any manufacturer's name, trade name, brand name, or catalog numbers used in the specifications is for the purpose of describing the quality level, performance and characteristics required. Bidder must specify the brand and model number of the product offered in his/her bid. Bids not specifying brand and model numbers will be considered as offering the exact product(s) specified in the IFB.

**4. Descriptive Information**

Bidders proposing an equivalent brand or model should submit information with bid (such as illustrations, descriptive literature, technical data) sufficient for the University to evaluate quality, suitability and compliance with the specifications in the IFB. Failure to submit descriptive information may cause bid to be rejected. Any change made to a manufacturer's published specification submitted for a product should be verifiable by the manufacturer. If item(s) bid do not fully comply with specifications (including brand and/or product number), bidder must state in what respect the item(s) deviate. Failure to note exceptions on the bid form will not relieve the successful bidder(s) from supplying the actual products requested.

**Document will be included with the successful vendor's contact.**

**5. ON-CAMPUS ATTENDANCE REQUIREMENTS (COVID-19)**

The Center for Disease and Control (CDC) recommends social distancing and wearing masks to prevent the spread of the Corona Virus (COVID-19).

**6. Prices**

Unless otherwise specified by the Purchasing Department, bid prices must be complete, including transportation, prepaid by bidder to destination. In the event of extension errors, the unit price shall prevail.

**7. Payment Terms**

Payment is to be made within thirty (30) days after receipt of properly executed invoice, or delivery and acceptance, whichever is later. Delinquent payment penalties are governed by **L.R.S. 39:1695**.

**8. Deliveries**

Bids may be rejected if the delivery or completion time indicated is longer than that specified in the IFB.

**9. Vendor Invoices**

Invoices or AIA payment form shall reference the Southern University purchase/release order number, vendor's packing list/delivery ticket, ticket number, shipping/delivery date, etc. Invoices are to be itemized and billed in accordance with the order and should show the amount of any prompt payment discount and submitted on the vendor's own invoice form. Invoices submitted by the vendor's supplier will not be accepted. Terms are net 30.

**10. Tax Information/State of Louisiana**

Vendor is responsible for including all applicable taxes in the bid prices. Southern University is exempt from all Louisiana state and local sales and use taxes. By accepting an award, resident and non-resident firms acknowledge their responsibility for the payment of all taxes duly assessed by the State of Louisiana and its political subdivisions for which they are liable, including but not limited to: franchise taxes, privilege taxes, sales taxes, use taxes, ad valorem taxes, etc. In accordance with Act Number 1029 of the 1991 Regular Session, effective September 1, 1991 state agencies will no longer be required to pay state sales tax.

**11. New Products**

Unless specifically called for, all products for purchases must be new (never previously used) and the current model and/or packaging. The manufacturer's standard warranty will apply unless otherwise specified in the IFB.

**12. Contract Renewals, Multi-Year Contracts (if applicable)**

Upon agreement of Southern University and the contractor, an open-ended requirements contract may be extended for two (2) additional twelve (12) month periods at the same prices, terms and conditions. In such cases, the total contract term cannot exceed thirty six (36) months.

**13. Contract Cancellation**

Southern University has the right to cancel any contract, in accordance with Purchasing Rules and Regulations, for cause, including but not limited to, the following: (1) failure to deliver within time specified in the contract; (2) failure of the product or service to meet specifications, conform to sample quality or to be delivered in good condition; (3) misrepresentations by the contractor; (4) fraud, collusion, conspiracy or other unlawful means of obtaining any contract with the state; (5) conflict of contract provisions with constitutional or statutory provision of state or federal law; (6) any other breach of contract.

**14. AWARD AND EXECUTION OF CONTRACT:**

The owner shall incur no obligation to the contractor until the contract between the owner and contractor is duly executed. If the contractor is notified of the acceptance of the bid within thirty (30) days of the opening bid date, contractor agrees to execute and deliver to owner, Performance and Payment Bond and Certificate of Insurance, a copy of which is attached to the Contract Documents, within ten (10) working days after notice from the Owner that the instrument is ready for signature.

**15. Fiscal Funding Clause (Renewal Contracts Only)**

**In accordance with LA R.S.39:1615 (c) and (e), any contract entered into by the State of Louisiana and Southern University shall include the following Fiscal Funding Clause:**

C. Termination due to unavailability of funds in succeeding years. When funds are not appropriated to support continuation of performance in a subsequent year of a multiyear contract, the contract for such subsequent year shall be terminated. When a contract is terminated under these conditions, no additional funds shall be paid to the contractor as a result of such action. E. With respect to all multiyear contracts, there shall be no provisions for a penalty to the state for the cancellation or early payment of the contract. The continuation of this contract is contingent upon the appropriation of funds to fulfill the requirements of the contract by the legislature. All proposers should be aware that our legislative process is such that it is often impossible to give prior notice of the non-appropriation of funds.

**Document will be included with the successful vendor's contact.**

**16. Default of Contactor**

Failure to deliver within the time specified in the bid will constitute a default and may cause cancellation of the contract. Where the state had determined the contractor to be in default, the state reserves the right to purchase any or all products or services covered by the contract on the open market and to charge the contractor with cost in excess of the contract price. Until such assessed charges have been paid, no subsequent bid from the defaulting contractor will be considered.

**17. Order of Priority**

In the event there is a conflict between the Instructions to Bidders the General Terms and Conditions will govern.

**18. Applicable Law**

All contracts will be construed in accordance with and governed by the laws of State of Louisiana. Vendors shall be in compliance with applicable laws of the State of Louisiana and Federal Laws where applicable, to include licenses, fees and permits. Vendors are responsible for the cost of licenses, fees and permits.

**19. Certification of No Suspension or Debarment (\$25,000 or more)**

By signing and submitting this bid, bidder certifies that its company, any subcontractors, or principals thereof, are not suspended or debarred under federal or state laws or regulations. A list of parties who have been suspended or debarred by federal agencies is maintained by the General Services Administration and can be viewed on the internet at [www.sam.gov](http://www.sam.gov).

**Federal Funded**       **Non-Federal Funded**

**20. E-VERIFY (verification of employees)**

Contractor acknowledges and agrees to comply with the provisions of La R.S. 38:2212.10 and federal law pertaining to E-Verify in the performance of services under this contract.

**21. Prohibited Contractual Arrangements**

Per Louisiana R.S. 42:1113.a, no public servant, or member of such public servant's immediate family, or legal entity in which he is a controlling interest shall bid on or enter into any contract, subcontract, or other transaction that is under the supervision or jurisdiction of the agency of such public servant. See statute for complete law, exclusions and provisions.

**22. Discriminatory Boycotts of Israel**

This section applies to procurements with a value of \$100,000 or more and for vendors with five (5) or more employees

**Prohibition of Discriminatory Boycotts of Israel**

In accordance with R.S. 39:1602.1, for any contract for \$100,000 or more and for any contractor with five or more employees, the Contractor certifies that neither it nor its subcontractors are engaged in a boycott of Israel, and that the Contractor and any subcontractors shall, for the duration of this contract, refrain from a boycott of Israel. The State reserves the right to terminate this contract if the Contractor, or any Subcontractor, engages in a boycott of Israel during the term of this contract.

**23. Mutual Indemnification**

Each party hereto agrees to indemnify, defend and hold the other, its officers, directors, agents and employees harmless from and against any and all losses, liabilities and claims, including reasonable attorney's fees arising out of or resulting from the willful act, fault, omission, or negligence of the indemnifying party or of its employees, contractors, or agents in performing its obligations under this agreement, provided however, that neither party hereto shall be liable to the other for any consequential damages arising out of its willful act, fault, omission, or negligence.

**24. Fair Labor Standards Act**

Contractor shall be in compliance with the **Fair Labor Standards Act 29 USC 201-6**; Establishes minimum wage, overtime pay, equal pay, recordkeeping, and child labor standards for employees or in the production of goods for interstate commerce. **By signing and submitting this bid, bidder certifies that its company, any subcontractors, or principals thereof is in accordance with said compliance.** United States Department of Labor website: [www.dol.gov/esa](http://www.dol.gov/esa)

**25. Davis-Bacon Act (\$2,000 or more)**

Contractor shall be in compliance with the **Davis-Bacon Act, 40 USC 276A-7**; ensures that laborers and mechanics employed pursuant to federally funded construction contracts, subcontracts and construction under Federal grants, will be paid wages as determined by the U.S. Secretary of Labor. **By signing and submitting this bid, bidder certifies that its company, any subcontractors, or principals thereof is in accordance with said compliance.** United States Department of Labor website: [www.dol.gov/esa](http://www.dol.gov/esa)

**Federal Funded**       **Non-Federal Funded**

**26. Small Business Entrepreneurship Programs**

Document will be included with the successful vendor's contact.



The Southern University System is a participant in the Louisiana for the Small Entrepreneurships Program (the Hudson Initiative) and the Louisiana Initiative for Veterans and Service-Connected Disabled Veterans-Owned Business Small Entrepreneurships. Bidders are encouraged to consider participation. A list of certified vendors and additional information can be obtained from website <http://www.ledsmallbiz.com>. Potential participants may also register at this website. Businesses include minority and women.

**27. Public Works Projects (R.S. 38:2227)**

In accordance with the provisions of R.S. 38:2227; in awarding public works projects, any public entity is authorized to reject a proposal or bid, or not award the contract, to a business in which any individual with an ownership interest of ten percent (10%) or more, has been convicted, or has entered a plea of guilty or nolo contendere to any state felony or equivalent federal felony crime.

**28. Tobacco-Free Policy**

The use of tobacco products on any Southern University campus is prohibited by students, staff, faculty or visitors in all campus buildings, facilities, or property owned or leased by Southern University System and outside areas of the campus where non-smokers cannot avoid exposure to smoke; on campus grounds, facilities, or vehicles that are the property of the University; and at lectures, conferences, meetings, and social and cultural events held on school property or school grounds. The sale or free distribution of tobacco products, including merchandise on campus or at school events is prohibited.

**29. Equal Opportunity Employer**

Southern University and A&M College Systems of the State of Louisiana is an equal opportunity employer and looks to its contractors, sub-contractors, vendors, and suppliers to take affirmative action to effect this commitment in its operations. By submitting and signing this bid, the bidder certifies that he agrees to adhere to the mandates dictated by Title VI and VII of the Civil Rights Act of 1964, as amended; the Vietnam Era Veterans' Readjustment Assistance Act of 1974; Section 303 of the Rehabilitation Act of 1973; Section 202 of Executive Order 12414, as amended; and the Americans with Disabilities Act of 1990. Bidder agrees that he will not discriminate in the rendering of services to and/or employment of individuals because of race, color, religion, sex, age, national origin, handicap, disability, veteran status, or any other non-merit factor. Bidder further agrees to keep informed of and comply with all Federal, State, and local laws, ordinances, and regulations which affect his employees or prospective employees. Any person who is a "Qualified Individual with a Disability" as defined by 42 USC 12131 of the American with Disabilities Act who has submitted a bid on this procurement and who desires to attend the bid opening, must notify this office in writing no later than seven (7) working days prior to the bid opening date of their need for special accommodations. If the requested accommodations cannot be reasonably provided, the individual will be so informed prior to the bid opening.

**30. Code of Ethics**

The contractor acknowledges that Chapter 15 of Title 42 of the Louisiana Revised Statutes (R.S. 42:1101 et. seq., Code of Governmental Ethics) applies to the Contracting Party in the performance of services called for in this contract. The contractor agrees to immediately notify the state if potential violations of the Code of Governmental Ethics arise at any time during the term of this contract.

**31. Vendor Forms/SU Signature Authority**

The terms and conditions of the SU solicitation and purchase order/contract shall solely govern the purchase agreement, and shall not be amended by any vendor contract, form, etc. The University's chief procurement officer, or designee, is delegated sole authority to execute any vendor contracts, forms, etc. Departments are prohibited from signing any vendor forms.

**32. Prosecution of Work**

The work is to be done when Southern University is in operation. The contractor shall, therefore, plan the repairs and installation in specifications so as not to interfere with normal operations of the facility and shall exert effort to expedite completion of the work once it has started. It is intended that the work shall be done during normal working hours, however, should work require overtime (Saturday, Sunday and/or night working hours), the cost must be borne by the contractor at no extra compensation from the Owner (Southern University).

**33. On-Campus Attendance Requirements (COVID-19)**

The Center for Disease and Control (CDC) recommends social distancing and wearing of masks to prevent the spread of the Coronavirus (COVID19). Persons visiting Southern University are required to wear a mask/face covering and stay at least 6 feet between yourself and others, even when you wear a face covering.

**34. Termination of the Contract for Convenience**

The State/University may terminate the contract at any time by giving thirty (30) days written notice to the Contractor of such termination or negotiating with the Contractor an effective date. The Contractor shall be entitled to payment for deliverables in progress, to the extent work has been performed satisfactorily.

**35. Termination for Cause**

The State may terminate this Contract for cause based upon the failure of the Contractor to comply with the terms and/or conditions of the Contract; provided that the State shall give the Contractor written notice specifying the Contractor's failure. If within thirty (30) days after receipt of such notice, the Contractor shall not have either corrected such failure or thereafter proceeded diligently to

**Document will be included with the successful vendor's contact.**

complete such correction, then the State may, at its option, place the Contractor in default and the Contract shall terminate on the date specified in such notice. The Contractor may exercise any rights available to it under Louisiana law to terminate for cause upon the failure of the Owner to comply with the terms and conditions of this contract; provided that the Contractor shall give the State written notice specifying the State's failure and a reasonable opportunity for the Owner to cure the defect.

**36. Auditors**

It is hereby agreed that the Legislative Auditor of the State of Louisiana and/or the Office of the Governor, Division of Administration auditors shall have the option of auditing all accounts of contractor which relate to this contract.

**37. Awarded Products/Unauthorized Substitutions**

Only those awarded brands and numbers stated in the SU contract are approved for delivery, acceptance, and payment purposes. Any substitutions require prior approval of the Purchasing Office. Unauthorized product substitutions are subject to rejection at time of delivery, post-return at vendor's expense, and non-payment.

**38. Acceptance**

Upon written notice by the Owner, a Notice by Owner of Acceptance of Work will be executed and forwarded to the Contractor for recording with the Clerk of Court in the parish in which the work has been performed and shall furnish a clear Lien Certificate from the Clerk of Court (to the owner along with final invoice) forty-five (45) days after recordation of acceptance. Final payment of ten percent (10%) will be made at this time.

**39. Guarantee**

It is the intention of the specifications to secure a first-class permanent material and construction and to this end, Contractor will be held responsible for and must correct defects discovered in the work within one (1) year from acceptance. Should any materials or methods be called for, of such nature to render this guarantee impossible, written notice to this effect should be given Owner (Southern University) before signing contract and/or beginning of work; failure to do this will be construed as agreement to the strictest terms of the guarantee.

**40. Clean-Up**

The Contractor will be directed during the progress of work to remove and properly dispose of the resultant and debris. Upon completion, Contractor shall remove all equipment, unused materials and debris and will leave the premises in a clean and first-class condition.

**41. Examination of Site**

Each bidder will visit the site of the proposed project and will fully acquaint himself with conditions relating to construction and labor so that he may fully understand the facilities, difficulties and restrictions attending the execution of work under this contract. No consideration or allowance will be granted the Contractor for failure to visit the site or for any alleged misunderstanding of the materials to be furnished or the work to be done.

**42. Anti-Kickback Clause**

The Contractor hereby agrees to adhere to the mandate dictated by The Copeland "Anti-Kickback" ACT which provides that each Contractor or Subgrantee shall be prohibited from inducing, by any means, any person employed in the completion of work, to give up any part of the compensation to which he is otherwise entitled.

**43. Clean Air Act**

The Contractor hereby agrees to adhere to the provisions which require compliance with all applicable standards, orders or requirements issued under Section 306 of the CLEAN AIR ACT which prohibits the use under non-exempt contracts, grants or loans of facilities included on the EPA list of Violating Facilities.

**44. Clean Water Act**

The Contractor hereby agrees to adhere to the provisions which require compliance with all applicable standards, orders or requirements issued under Section 508 of the Clean Water Act which prohibits the use under non-exempt federal contracts, grants or loans of facilities included on the EPA list of Violating Facilities.

**45. Energy Policy and Conservation Act**

The Contractor hereby recognizes the mandatory standards and policies relating to energy efficiency which are contained in the State energy conservation plan issued in compliance with the Energy Policy and Conservation Act (P.L. 94-163).

**46. Anti-Lobbying and Debarment Act**

The Contractor will be expected to comply with federal statutes in the Anti-Lobbying Act and The Debarment Act.

**47. Signature Authority**

**A CORPORATE RESOLUTION OR WRITTEN EVIDENCE OF THE AUTHORITY OF THE PERSON SIGNING THE BID FOR THE PUBLIC WORK AS PRESCRIBED BY LOUISIANA REVISED STATUTE 38:2212 (B)(5)**

Document will be included with the successful vendor's contact.

**A copy of the applicable signature authority document/Board Resolution or LA Secretary of State Registration must be submitted with bid.**

**48. ADDITIONAL REQUIREMENTS**

1. ALL WORK SHALL BE IN ACCORDANCE WITH THE PLANS; THE PROJECT SPECIFICATIONS, AND SHALL COMPLY WITH APPLICABLE LOCAL AND STATE BUILDING CODES AS WELL AS ANY AND ALL REGULATORY AGENCY REQUIREMENTS AND LAWS, INCLUDING BUT NOT LIMITED TO OSHA, ETC. GENERAL NOTES SHALL APPLY TO ALL DRAWINGS.
2. CONTRACTOR SHALL NOTIFY THE ENGINEER/ARCHITECT, IF APPLICABLE, OF ALL CONFLICTS OR DISCREPANCIES PRESENTED IN THESE PLANS PRIOR TO THE START OF WORK.
3. ALL WORK WHETHER SHOWN OR IMPLIED, UNLESS SPECIFICALLY QUESTIONED SHALL BE CONSIDERED UNDERSTOOD IN ALL RESPECTS BY THE GENERAL CONTRACTOR AND WHO WILL BE RESPONSIBLE FOR ANY MISINTERPRETATIONS AND CONSEQUENCES THEREOF.
4. ANY UTILITIES DAMAGED DURING CONSTRUCTION SHALL BE REPAIRED AT THE CONTRACTOR'S EXPENSE.
5. ENGINEER/ARCHITECT SHALL BE NOTIFIED IMMEDIATELY OF ALL IDENTIFIED EXISTING UTILITIES NOT IDENTIFIED IN THE PLANS.
6. OWNER SHALL PROVIDE WATER FOR CLEANING OPERATIONS FROM ANY FIRE HYDRANT AT NO COST TO THE CONSULTANT.

**THIS DOCUMENT IS FOR INFORMATION PURPOSES**

**Document will be included with the successful vendor's contract.**

**JOB SITE VISIT**

**NAME OF PROJECT: TENNIS COURTS & LIGHTING**

**SOUTHERN UNIVERSITY AND A & M COLLEGE**

**BATON ROUGE, LOUISIANA**

**SITE VISIT DATE: APRIL 30, 2024 @ 10:30 AM-BID # 10315**

**LATE ARRIVALS CANNOT PARTICIPATE IN THE BID PROCESS**

*It is the responsibility of the bidder to inspect job site, verify any measurements and/or supplies needed prior to submitting a bid price on this project. Each bidder shall fully acquaint himself with conditions relating to construction and labor so that he may fully understand the facilities, difficulties and restrictions attending the execution of work under this contract. If vendor finds conditions that disagree with the physical layout as described in the bid, or any other features of the specifications that appear to be in error, same shall be noted on proposal. Failure to do so will be interpreted that bid is as specified. No consideration or allowance will be granted the Contractor for failure to visit the site or for any alleged misunderstanding of the materials to be furnished or the work to be done.*

**JOB SITE VISIT LOCATION:**

**Benjamin H. Kraft Building (Physical Plant Department)**

**515 James L. Hunt Street**

**Southern University Baton Rouge Campus**

**Site telephone numbers: (225) 771-4741, 771-4742 or 771-4743**

*The signed statement certifies the vendor's name listed below has visited the proposed site and is familiar with all conditions surrounding fulfillment of the specifications for this project.*

COMPANY \_\_\_\_\_

BY \_\_\_\_\_

DATE \_\_\_\_\_

**Note:** Questions not answered at Site Visit or any additional questions shall be submitted in writing to the Director of Purchasing, Linda A. Antoine at [linda\\_antoine@subr.edu](mailto:linda_antoine@subr.edu).

**Note:** Responses to inquiries/Addenda are pasted on LaPAC (LA Procurement Website)

LA State Procurement website:

<https://wwwcfprd.doa.louisiana.gov/OSP/LaPAC/Agency/outMain.cfm>

**It is the responsibility of the vendor to check LAPAC for addenda.**

**JOB SITE VERIFIED BY DESIGNATED SOUTHERN UNIVERSITY EMPLOYEE:**

\_\_\_\_\_  
SIGNATURE

Return this sheet with bid for information purpose

for assessments under any form of the policies.

- d. Any failure of the Contractor to comply with reporting provisions of the policy shall not affect coverage provided to the Agency, its officers, agents, employees and volunteers.

**D. ACCEPTABILITY OF INSURERS**

All required insurance shall be provided by a company or companies lawfully authorized to do business in the jurisdiction in which the Project is located. Insurance shall be placed with insurers with a A.M. Best's rating of **A-VI or higher**. This rating requirement may be waived for workers compensation coverage only.

If at any time an insurer issuing any such policy does not meet the minimum A.M. Best rating, the Contractor shall obtain a policy with an insurer that meets the A.M. Best rating and shall submit another Certificate of Insurance as required in the contract.

**E. VERIFICATION OF COVERAGE**

Contractor shall furnish the Agency with Certificates of insurance reflecting proof of required coverage. The Certificates for each insurance policy are to be signed by a person authorized by that insurer to bind coverage on its behalf. The Certificates are to be received and approved by the Agency before work commences and upon any contract renewal thereafter.

In addition to the Certificates, Contractor shall submit the declarations page and the cancellation provision endorsement for each insurance policy. The Agency reserves the right to request complete certified copies of all required insurance policies at any time.

Upon failure of the Contractor to furnish, deliver and maintain such insurance as above provided, this contract, at the election of the Agency, may be suspended, discontinued or terminated. Failure of the Contractor to purchase and/or maintain any required insurance shall not relieve the Contractor from any liability or indemnification under the contract.

**F. SUBCONTRACTORS**

Contractor shall include all subcontractors as insureds under its policies OR shall be responsible for verifying and maintaining the Certificates provided by each subcontractor. Subcontractors shall be subject to all of the requirements stated herein. The Agency reserves the right to request copies of subcontractor's Certificates at any time.

**G. WORKERS COMPENSATION INDEMNITY**

In the event Contractor is not required to provide or elects not to provide workers compensation coverage, the parties hereby agree that Contractor, its owners, agents and employees will have no cause of action against, and will not assert a claim against, the State of Louisiana, its departments, agencies, agents and employees as an employer, whether pursuant to the Louisiana Workers Compensation Act or otherwise, under any circumstance. The parties also hereby agree that the State of Louisiana, its departments, agencies, agents and employees shall in no circumstance be, or considered as, the employer or statutory employer of Contractor, its owners, agents and employees. The parties further agree that Contractor is a wholly independent contractor and is exclusively responsible for its employees, owners, and agents. Contractor hereby agrees to protect, defend, indemnify and hold the State of Louisiana, its departments, agencies, agents and employees harmless from any such assertion or claim that may arise from the performance of this contract.

***Maritime (Jones Act and LHWCA) needed when work is performed over navigable bodies of water***

**H. INDEMNIFICATION/HOLD HARMLESS AGREEMENT**

Contractor agrees to protect, defend, indemnify, save, and hold harmless, the State of Louisiana, all State Departments, Agencies, Boards and Commissions, its officers, agents, servants, employees, and volunteers, from and against any and all claims, damages, expenses, and liability arising out of injury or death to any person or the damage, loss or destruction of any property which may occur, or in any way grow out of, any act or omission of Contractor, its agents, servants, and employees, or any and all costs, expenses and/or attorney fees incurred by Contractor as a result of any claims, demands, suits or causes of action, except those claims, demands, suits, or causes of action arising out of the negligence of the State of Louisiana, all State Departments, Agencies, Boards, Commissions, its officers, agents, servants, employees and volunteers.

Contractor agrees to investigate, handle, respond to, provide defense for and defend any such claims, demands, suits, or causes of action at its sole expense and agrees to bear all other costs and expenses related thereto, even if the claims, demands, suits, or causes of action are groundless, false or fraudulent.

**NOTE: SUCCESSFUL BIDDER WILL BE REQUIRED TO PROVIDE A CERTIFICATE OF INSURANCE WITH SOUTHERN UNIVERSITY AS THE CERTIFICATE HOLDER  
SOUTHERN UNIVERSITY AND A&M COLLEGE  
PO BOX 9534  
BATON ROUGE, LA 70813  
225-771-4587**

## **INSURANCE REQUIREMENTS**

**Southern University and A&M College**

**TENNIS COURTS & LIGHTING**

**BID # 10319**

The Contractor shall purchase and maintain for the duration of the contract insurance against claims for injuries to persons or damages to property which may arise from or in connection with the performance of the work hereunder by the Contractor, its agents, representatives, employees or subcontractors.

### **A. MINIMUM SCOPE AND LIMITS OF INSURANCE**

1. **Workers Compensation**

Workers Compensation insurance shall be in compliance with the Workers Compensation law of the State of the Contractor's headquarters. Employers Liability is included with a minimum limit of \$500,000 per accident/per disease/per employee. If work is to be performed over water and involves maritime exposure, applicable LHWCA, Jones Act, or other maritime law coverage shall be included and the Employers Liability limit increased to a minimum of \$1,000,000. **A.M. Best's insurance company rating requirement may be waived for workers compensation coverage only.**

2. **Commercial General Liability**

Commercial General Liability insurance, including Personal and Advertising Injury Liability, shall have a minimum limit per occurrence of \$1,000,000 and a minimum general aggregate of \$2,000,000. The Insurance Services Office (ISO) Commercial General Liability occurrence coverage form CG 00 01 (current form approved for use in Louisiana), or equivalent, is to be used in the policy. Claims-made form is unacceptable.

3. **Automobile Liability**

Automobile Liability Insurance shall have a minimum combined single limit per occurrence of \$1,000,000. ISO form number CA 00 01 (current form approved for use in Louisiana), or equivalent, is to be used in the policy. This insurance shall include third-party bodily injury and property damage liability for owned, hired and non-owned automobiles.

### **B. DEDUCTIBLES AND SELF-INSURED RETENTIONS**

Any deductibles or self-insured retentions must be declared to and accepted by the Agency. The Contractor shall be responsible for all deductibles and self-insured retentions.

### **C. OTHER INSURANCE PROVISIONS**

The policies are to contain, or be endorsed to contain, the following provisions:

1. **General Liability and Automobile Liability Coverage**

- a. The Agency, its officers, agents, employees and volunteers shall be named as an additional insured as regards negligence by the contractor. ISO Form CG 20 10 (current form approved for use in Louisiana), or equivalent, is to be used when applicable. The coverage shall contain no special limitations on the scope of protection afforded to the Agency.
- b. The Contractor's insurance shall be primary as respects the Agency, its officers, agents, employees and volunteers. Any insurance or self-insurance maintained by the Agency shall be excess and non-contributory of the Contractor's insurance.
- c. Any failure of the Contractor to comply with reporting provisions of the policy shall not affect coverage provided to the Agency, its officers, agents, employees and volunteers.
- d. The Contractor's insurance shall apply separately to each insured against whom claim is made or suit is brought, except with respect to the policy limits.

2. **Workers Compensation and Employers Liability Coverage**

The insurer shall agree to waive all rights of subrogation against the Agency, its officers, agents, employees and volunteers for losses arising from work performed by the Contractor for the Agency.

3. **All Coverage**

- a. Coverage shall not be canceled, suspended, or voided by either party (the Contractor or the insurer) or reduced in coverage or in limits except after 30 days written notice has been given to the Agency. Ten-day written notice of cancellation is acceptable for non-payment of premium. Notifications shall comply with the standard cancellation provisions in the Contractor's policy.
- b. Neither the acceptance of the completed work nor the payment thereof shall release the Contractor from the obligations of the insurance requirements or indemnification agreement.
- c. The insurance companies issuing the policies shall have no recourse against the Agency for payment of premiums or

## SCOPE OF WORK

Southern University  
New Tennis Court Facility  
Baton Rouge, LA

### **Installation of Three (3) New Post Tensioned Concrete Courts in compliance with NCAA Design and Construction Plans and Specifications**

Bid should include prices for Non-Encapsulated Post Tensioned concrete slab(s), lighting, fencing, surfacing, & accessories. See scope below for exact description.

The owner will provide direct suitable access to the construction site. This access will accommodate very large trucks such as cement trucks, concrete pump trucks and other large vehicles that are necessary for court installation process.

Any stone base, drive mats or crane mats needed to access the site as needed by Contractor will be the owners' responsibility.

Prior to the commencement of the work, the owner will be responsible for locating and marking any private underground utilities, (i.e. water lines, gas lines, septic line, etc.) Contractor will contact all Public Utilities prior to excavating.

The procedure for court construction will be as follows:

#### **PHASE I. Site Work**

- A. Owner to mark out the four corners and establish a benchmark.
- B. Owner to complete all site work and dirt work. Dirt pad shall be compacted to 95% standard and graded to within 1/10 ft of grade.
- C. Owner will provide the proper slope on the dirt pad. We recommend a maximum slope of 1" per every 10' (0.83% slope). We also recommend that the courts slope in a single plane from East to West or from West to East.
- D. Owner shall have site properly graded to shed water and to prevent ponding of water on the jobsite.
- E. Owner will supply all grade fill and/or sand fill if required.
- F. Contractor will layout courts and verify elevations and corners with Owner.
- G. Contractor will fine grade the subgrade (up to 1" deviation) using fill sand provided by Owner.
- H. Contractor will clean up all court construction debris (Owner to supply dumpster, or other method of disposal for construction debris)
- I. Owner to grade out and supply all landscaping around slabs after slabs are poured.
- J. Contractor not responsible for ruts left on site caused by court

construction or surfacing process. Owner shall provide direct access and maintain suitable access throughout the project.

**PHASE II. Slab Construction Phase**

- A. Contractor will provide an Engineered shop drawing for the PT slab foundation. The slab will be Engineered to meet a minimum of 125 PSI residual compressive strength.
- B. Contractor will install PT slab foundation for (3) courts to the dimensions shown on plans. The overall slab area will be (121'- 6" x 181'-5" @ 5" thick) to accommodate 6 full size tennis courts.
- C. Contractor will dig perimeter footings (12-inch-wide x 12 inch deep).
- D. Contractor will install a double 6mill polyethylene moisture barrier.
- E. Contractor will install one-half inch post-tension cables on center in both directions of the slab as per the Engineered PT slab drawing.
- F. The court will be poured with 3,500 psi concrete, straight cement mix with Mid-Range water Reducing agent. No Fly-ash is allowed in concrete mix design. Fly-ash prevents the adhesion of the court paint.
- G. Contractor will supply a concrete pump truck.
- H. Contractor will fully stress cables approximately one week after the concrete is poured

**PHASE III. Tennis Court Fencing – Black Vinyl**

- A. Contractor will Supply and Install Black Vinyl fencing around court(s), includes: 485' of 10ft tall and 198' of 4ft tall fencing.
- B. Includes top and bottom railing.
- C. Includes (6) 4'x7' gates, & (1) 4'x4' gates.
- D. Specifications for the fence material are as follows:
  - a. 3" SS40 Terminal & corner posts
  - b. 3" SS40 line posts
  - c. 1 5/8" railings as per plans (continuous top & bottom railing).
  - d. 9 gage core, 8gage finish, Class 2B Fused and Bonded Black Vinyl chain link fence mesh, 1 3/4 inch mesh

**PHASE IV. Court Net, Net Posts, & accessories**

- A. (3) sets of 3" galvanized Net post sleeves and galvanized center Anchors installed on the court prior to pouring the concrete slab.
- B. (3) sets of 3" Internal wind net posts (black) will be installed.
- C. (3) 3.5 mm tournament quality nets installed.
- D. 485' of 9ft tall VCP windscreen (black color) on all 10ft fencing
- E. (6) custom S.U. windscreen logos (solid white/Gold TBD).
- F. (1) 10ft Cabana Canopy with 8ft Benches. Players benches
- G. (1) water coolers, with stand, and trash can.
- H. (3) Tidy Court ball holder, trash can, score keeper combo
- I. (6) vinyl court numbers (fence mount)



**PHASE V. Surface Phase (QCI Classic Surfacing system or equal)**

- A. Court shall be surfaced, and striped using the Premium QCI Classic surfacing system or equal. Standard colors should be included in this bid.
- B. Contractor will install 2" white lines for all court markings.

**PHASE VI: Furnish LED Court lighting: Zone (Large) lighting system – LSI or equal.**

- A. Includes (14) (Anchor base / direct burial) light poles.
- B. Includes bracket arms for all poles.
- C. Includes (8) LED lights per court – total (24) fixtures.
- D. Contractor will install all pole foundations, set light poles, install brackets, and install all fixtures.
- E. Contractor will run conduit to each of the poles and receptacles.
- F. Owner to run all wire inside conduits and will terminate all connections.
- G. Owner to install conduits from the service panel to the edge of the slab of the new courts and terminate all connections.
- H. Owner responsible for service panel, meter pan, control cabinet,
- I. breakers and switches to complete the project.

**Add Alt: 1. Trench drain between courts 4&5. Includes one (1) 12" W x 24" D concrete channels, rebar reinforced, 121.5' of 4" wide trench drains. No exterior drainage beyond the limit of the slab is included in this price.**

**Additional Terms and Conditions:**

- 1. Owner will provide a method of disposal for all court construction debris.
- 2. Owner will be responsible for the cost of licenses and/or permits required for this job.
- 3. Owner responsible for all dirt work, and compaction, unless otherwise specified in the scope above. If owner is responsible for installing the sub-base, then Owner will be responsible for providing a suitable subbase and is responsible for its integrity. Any structural problems that arise on this project because of subbase failures, will be the owner's responsibility to fix or repair, at no cost to Contractor.
- 4. No surfacing work will be performed during periods of inclement weather. Surfacing materials must not be installed if temperatures are below 50 degrees, or if it has recently rained, or if there is threat of rain within a 24hr period after the paint is to be applied. Temperatures must be 50 degrees and rising, with no chance of rain before or after surfacing is to be installed. 24 hrs. of cure time must be given between every coat of material. More curing time will be required during colder overcast conditions. Weather delays will require additional time to complete without liquidated damages being accessed to Contractor.

**NCAA Tennis Courts  
Design and Construction Plans and Specifications  
For 1 and 2 Court Battery Layout**

Governing Entity: **INTERCOLLEGIATE TENNIS ASSOCIATION**

2022-23 ITA Rule Book:

[https://ncaaorg.s3.amazonaws.com/championships/sports/tennis/rules/2022-23PRXTE\\_ITARulesBook.pdf](https://ncaaorg.s3.amazonaws.com/championships/sports/tennis/rules/2022-23PRXTE_ITARulesBook.pdf)

**III . FACILITIES AND EQUIPMENT (page 65 of the 2022-23 ITA Rule Book)**

**III . FACILITIES AND EQUIPMENT A . Varsity Quality Tennis Facility**

A varsity quality tennis facility is one used exclusively for tennis. The playing surface shall be of hard court construction, designed specifically for tennis and coated with a recognized tennis surface. The only lines on the playing surface shall be standard tennis court lines, including USTA approved 36' and 60' lines within the same color family as the interior court. A multi-purpose recreational facility is not acceptable.

1. *Outdoor facilities.* The playing surface shall extend to the back fence behind each baseline. Each back fence shall be located at least 18 feet behind the baseline of the court and should be at least eight feet high. To ensure proper ball visibility, there should be wind screens on the back fences behind the baselines. Spectator seating behind the court should not be provided where the movement of spectators would distract the players on court.

The distance between the doubles lines of adjacent courts shall be at least 10 feet, provided there is no fence or divider netting between the courts. Where they exist, walls and other fixed objects

Intercollegiate Tennis Association (ITA) Regulations 65

66

shall be padded with shock absorbing material. The padding should

extend from the court surface vertically for a minimum of seven feet.

2. *Indoor facilities.* The playing surface shall extend from the backdrop to the backdrop. Each backdrop shall be located at least 18 feet behind the baseline of the court. To ensure proper ball visibility, it is imperative to have adequate contrast between the backdrop, the rear of the court and the tennis ball. Therefore, solid backdrop curtains shall be provided at a reasonable height behind the court. Spectator seating behind the court should not be provided where the movement of spectators would distract the players on court. The clear height of the finished ceiling shall be at least 18 feet above the court surface at the backdrop curtain, at least 21 feet at the court baselines, and at least 35 feet at the net line. The distance between the doubles lines of adjacent courts shall be at least 10 feet, provided there is no divider netting between the adjacent courts. The minimum distance from the doubles

sideline of a court to a divider net shall be nine feet. Lighting for indoor tennis shall be glare free and provide visibility of the ball for players and spectators from the time it is tossed in the air by the server along every path it follows, as long as the ball is in play. The average maintained light intensity shall be 75 foot-candles within the Primary Playing Area (PPA), with individual light fixtures placed in locations as specified by USTA guidelines for indoor courts. The uniformity ratio (max./min.) of lighting levels within the PPA of the court shall be between 1.5 to 2.0. All fixtures shall be located outside the doubles sidelines of the tennis courts. Where they exist, support columns and other fixed objects in the building shall be padded with shock absorbing material. Any fixed object within two feet of an opaque curtain should be padded. The padding should extend from the court surface vertically for a minimum of seven feet.

3. Please note that although facilities designed before Jan. 1, 2012, are not required to adhere to these guidelines, a best effort should be made to meet these guidelines. Any matches played at an indoor or outdoor facility not meeting these standards must be agreed to in writing by both coaches before the start of the match.

(Revised August 2021)

American Sports Builders Design Standards and Specifications for USTA

<https://sportsbuilders.org/page/TennisConstructionGuidelines> (See attached)

**6 SECTION - CONCRETE FENCE POST FOUNDATION**  
 T-2 NOT TO SCALE

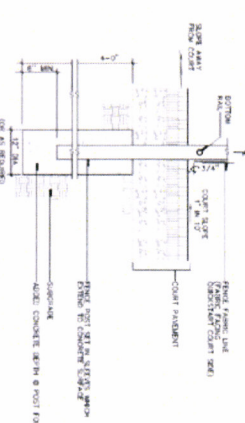

**1 ELEVATION - 60 FOOT QUICKSTART COURT LINE LAYOUT**  
 T-2 NOT TO SCALE

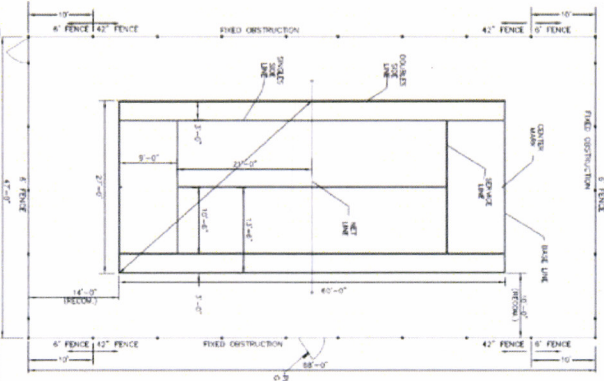

**2 CENTER STRAP ANCHOR DETAIL**  
 T-2 NOT TO SCALE

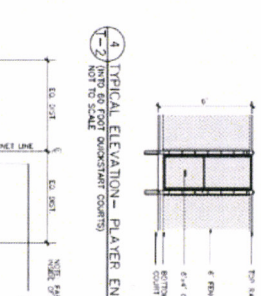

**4 TYPICAL ELEVATION - PLAYER ENTRANCE GATE**  
 T-2 NOT TO SCALE

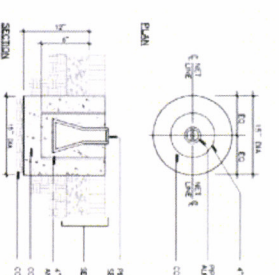

**5 ELEVATION - 42" HIGH FENCE - GATE #3**  
 T-2 NOT TO SCALE

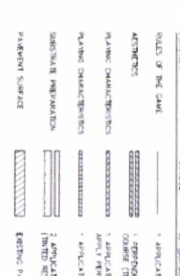

**7 COURT SURFACING SYSTEM**  
 T-2 NOT TO SCALE

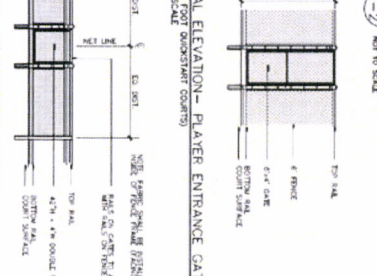

**3 NET POST DETAIL - 60 FOOT COURT**  
 T-2 NOT TO SCALE

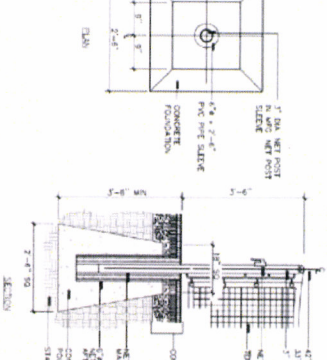

**8 ELEVATION ENLARGEMENT DOUBLE TOP RAIL FENCE**  
 T-2 NOT TO SCALE

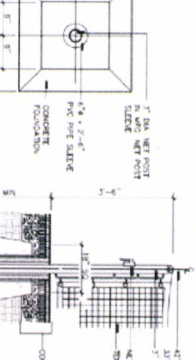

FUNCTION	SYMBOL	APPLICATION
FIELD OF THE COURT	[Symbol]	APPLICATIONS WITH REINFORCED CONCRETE (SEE PART 1) (SEE PART 2)
ACTIVITIES	[Symbol]	CONCRETE FOUNDATION FOR SAND TRAP
PLANE CONSTRUCTION	[Symbol]	APPLICATIONS FOR SAND TRAP COVERS (PART 1)
PLANE CONSTRUCTION	[Symbol]	APPLICATIONS FOR SAND TRAP COVERS (PART 2)
DETAILS PREPARATION	[Symbol]	APPLICATIONS FOR SAND TRAP COVERS (PART 3)
DETAILS PREPARATION	[Symbol]	APPLICATIONS FOR SAND TRAP COVERS (PART 4)
PLAYERS SURFACE	[Symbol]	APPLICATIONS FOR SAND TRAP COVERS (PART 5)
PLAYERS SURFACE	[Symbol]	APPLICATIONS FOR SAND TRAP COVERS (PART 6)

**PROJECT NAME**  
**60 FOOT TENNIS**

UNITED STATES TENNIS ASSOCIATION  
 70 WEST 38TH ST. 6TH FL. NEW YORK, NY 10018  
 DAVID W. LALON, TENNIS FACILITY CONSULTANT  
 1540 47TH ST. 4TH FL. BROOKLYN, NY 11220  
 (718) 861-2900

DESIGNED BY: **DMC**  
 CHECKED BY: **VC**

DATE: **12/20/2018**

SCALE: **AS SHOWN**

DRAWING NO.: **T-2 COURT DETAILS - NEW CONSTRUCTION**

Single (1-Court)

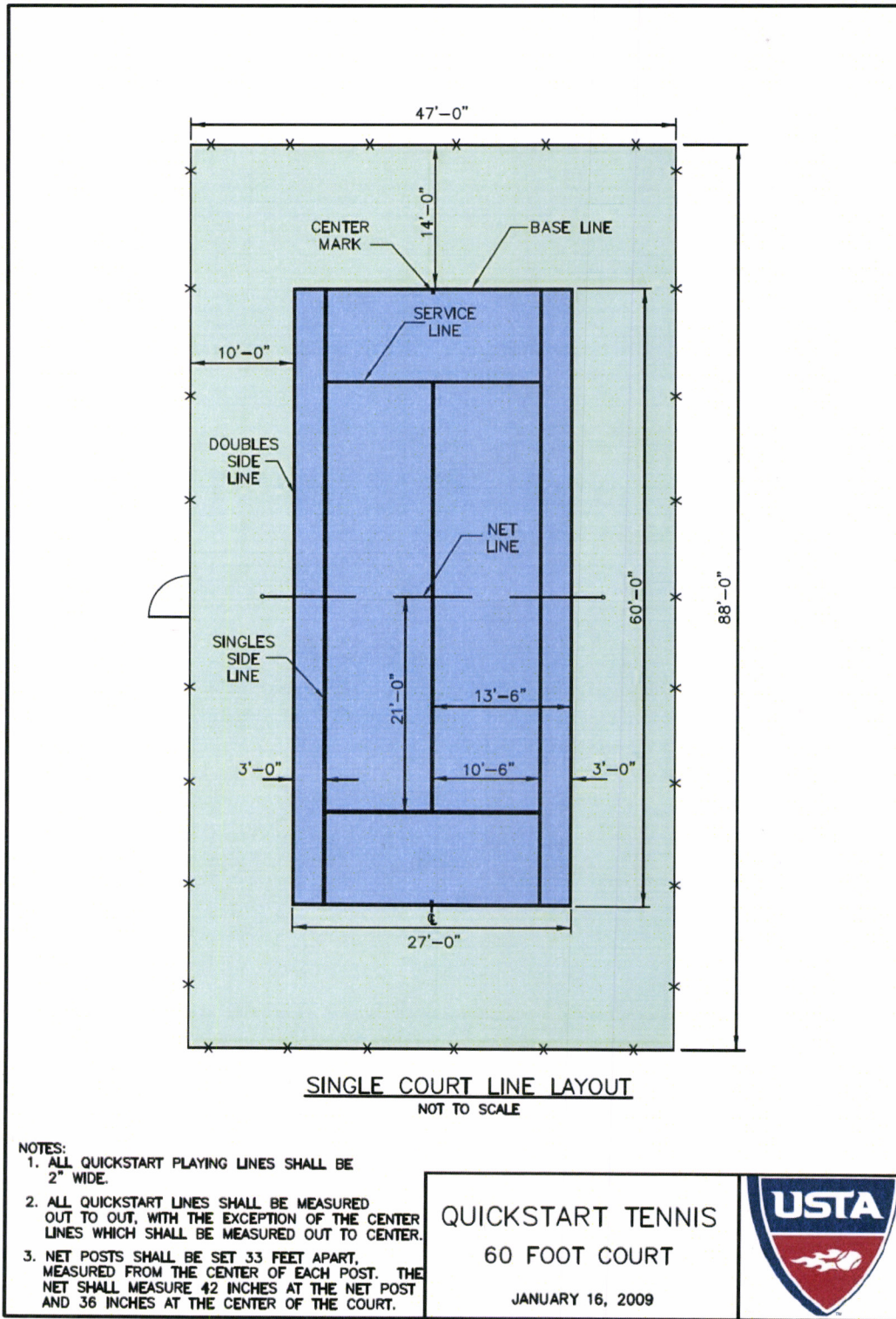

<p>QUICKSTART TENNIS</p> <p>60 FOOT COURT</p> <p>JANUARY 16, 2009</p>	
---	---

Double (2-Courts)

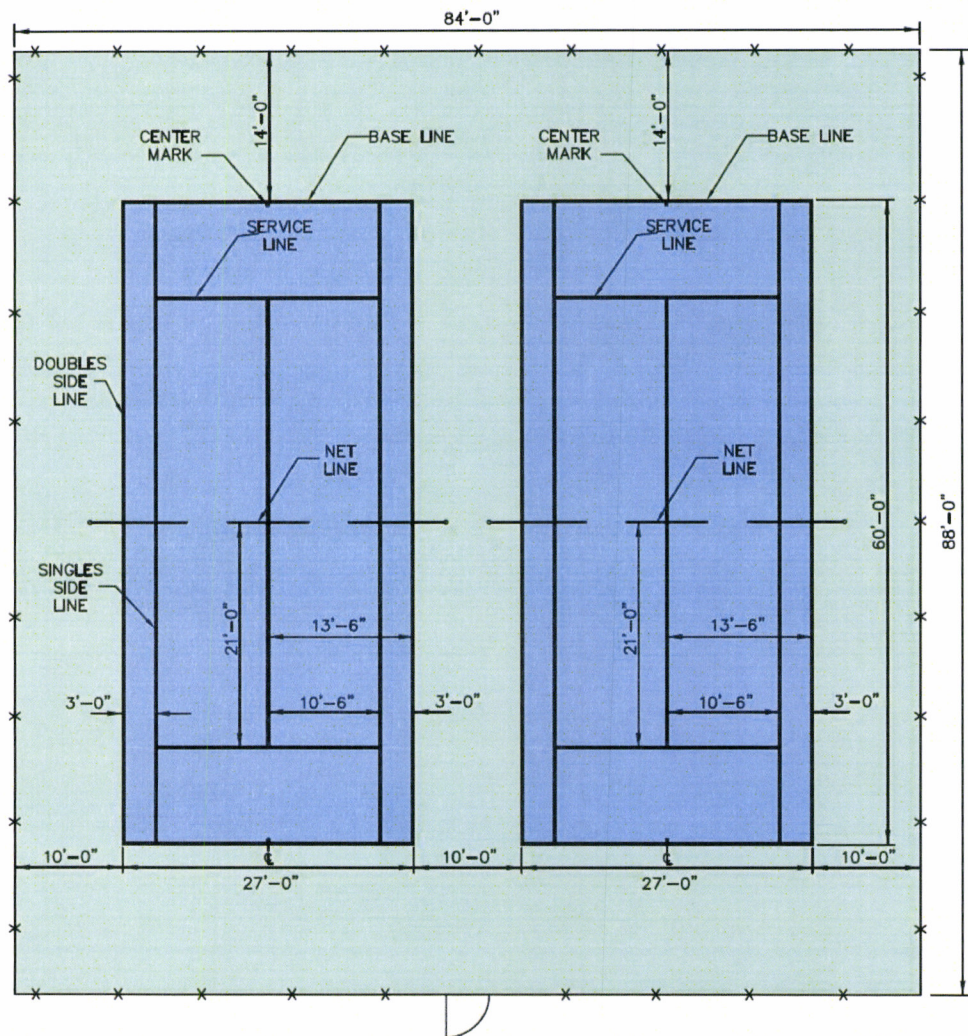

**TWO COURT BATTERY LAYOUT**  
NOT TO SCALE

**NOTES:**

1. ALL QUICKSTART PLAYING LINES SHALL BE 2" WIDE.
2. ALL QUICKSTART LINES SHALL BE MEASURED OUT TO OUT, WITH THE EXCEPTION OF THE CENTER LINES WHICH SHALL BE MEASURED OUT TO CENTER.
3. NET POSTS SHALL BE SET 33 FEET APART, MEASURED FROM THE CENTER OF EACH POST. THE NET SHALL MEASURE 42 INCHES AT THE NET POST AND 36 INCHES AT THE CENTER OF THE COURT.

QUICKSTART TENNIS  
60 FOOT COURT

JANUARY 16, 2009



Southern University - (6) courts with out drains

362'-9"

121'-6"

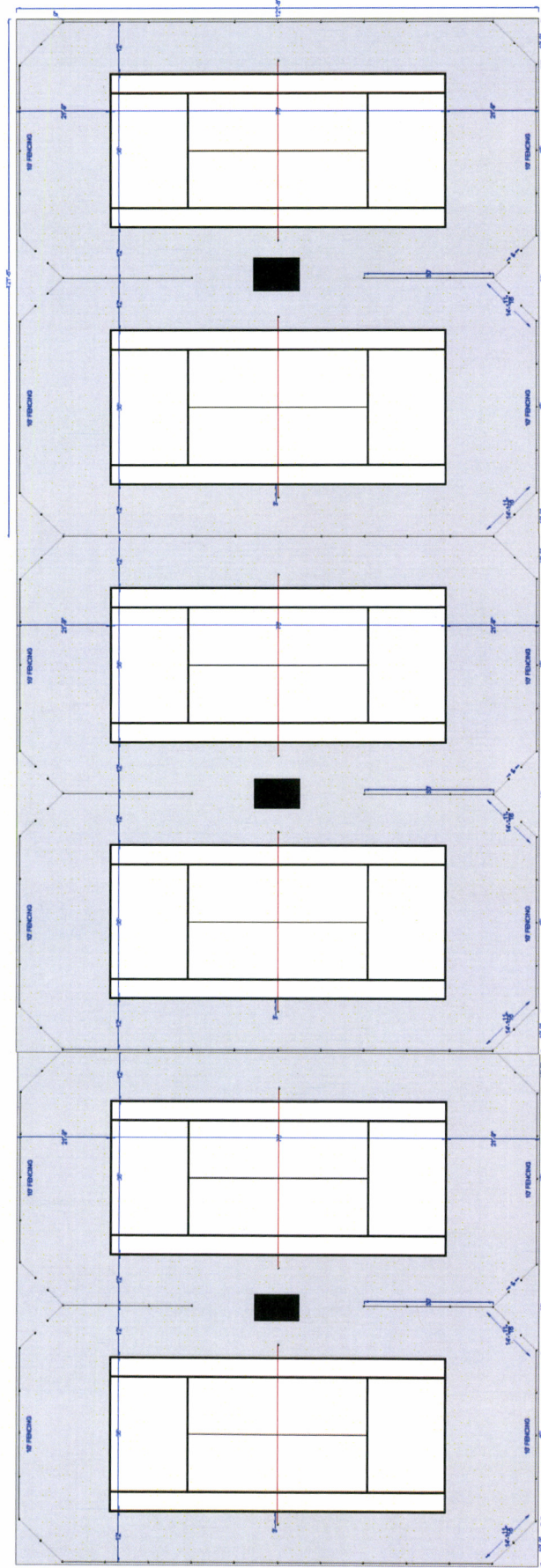

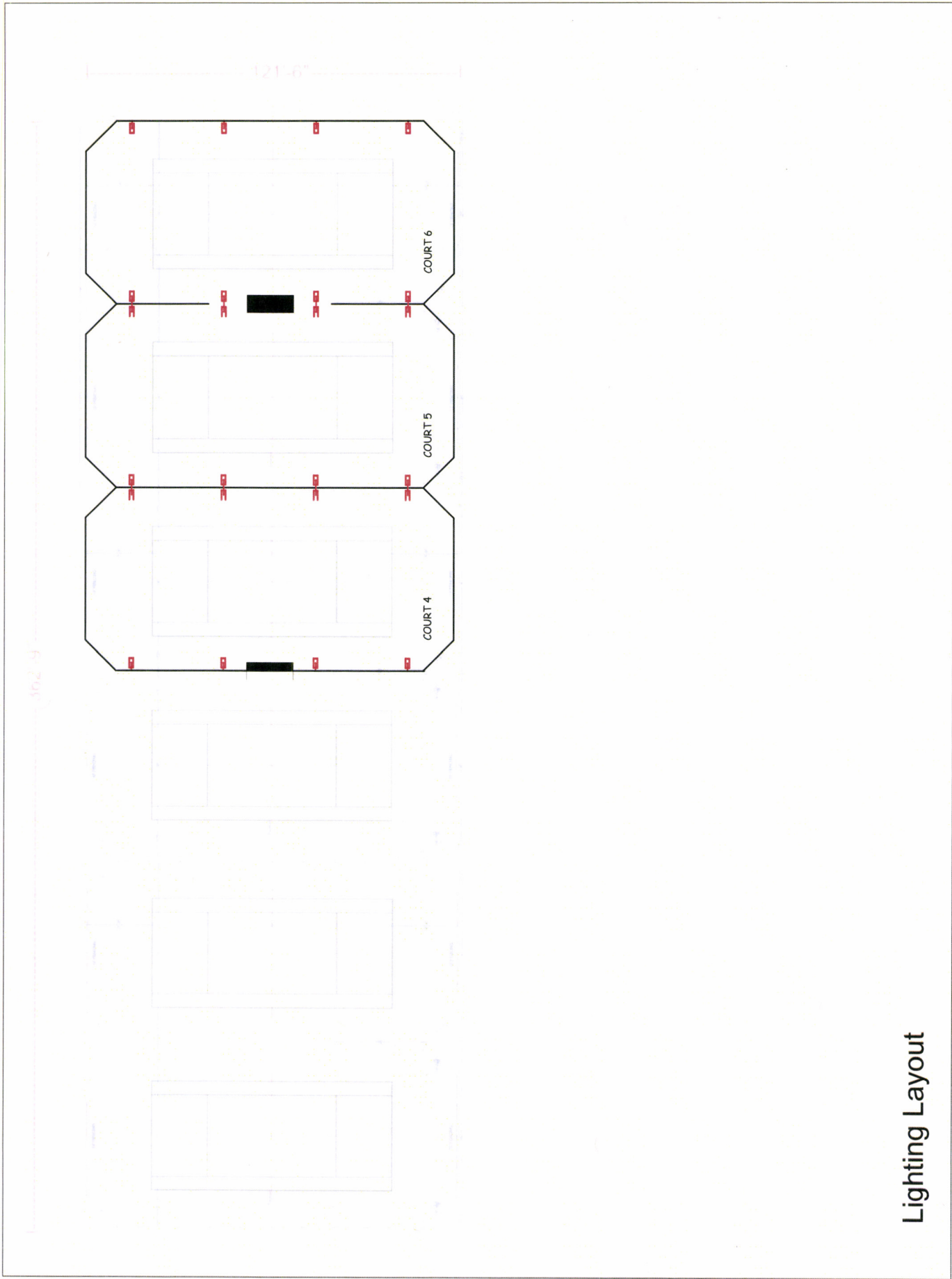

Lighting Layout





Catalog #: \_\_\_\_\_ Project: \_\_\_\_\_

Prepared By: \_\_\_\_\_ Date: \_\_\_\_\_ Type: \_\_\_\_\_

# ZONE™ Large (ZNL)

## Outdoor Sports Light



**ZONE**

OVERVIEW	
Lumen Range	50,000 -78,000
Wattage Range	375 - 648
Efficacy Range (LPW)	114 - 146
Weight lbs (kg)	60 (27.2)

### QUICK LINKS

[Ordering Guide](#)

[Performance](#)

[Photometrics](#)

[Dimensions](#)

### FEATURES & SPECIFICATIONS

#### Construction

- Rugged die-cast aluminum housing contains factory prewired driver and optical unit. Cast aluminum wiring access door located underneath.
- Fixtures are finished with LSI's DuraGrip® polyester powder coat finishing process. The DuraGrip finish withstands extreme weather changes without cracking or peeling. Other standard LSI finishes available. Consult factory.
- Shipping weight: 68 lbs in carton.

#### Optical System

- State-of-the-Art one piece silicone optic sheet delivers industry leading optical control with an integrated gasket to provide IP66 rated seal.
- Proprietary silicone refractor optics provide exceptional coverage and uniformity in distribution types 2, 3, 5W, FT, FTA and AM.
- Silicone optical material does not yellow or crack with age and provides a typical light transmittance of 95%.
- Zero uplight.
- Available in 5000K, 4000K, and 3000K color temperatures per ANSI C78.377.
- Minimum CRI of 70
- Integral louver (IL) and house-side shield (IH) options available for improved backlight control without sacrificing street side performance. See page 3 for more details.

#### Electrical

- High-performance driver features overvoltage, under-voltage, short-circuit

- and over temperature protection.
- 0-10V dimming (10% - 100%) standard.
- Standard Universal Voltage (120-277 VAC) Input 50/60 Hz or optional High Voltage (347-480 VAC).
- L90 Calculated Life: >100k Hours (See Lumen Maintenance on Page 3)
- Total harmonic distortion: <20%
- Operating temperature: 50L and 60L: -40°C to +50°C (-40°F to +122°F). 65L and 78L: -40°C to +40°C (-40°F to +104°F)
- Power factor: >.90
- Input power stays constant over life.
- Field replaceable 10kV surge protection device meets a minimum Category C Low operation (per ANSI/IEEE C62.41.2).
- High-efficacy LEDs mounted to metal-core circuit board to maximize heat dissipation
- Driver is fully encased in potting material for moisture resistance and complies with FCC standards. Driver and key electronic components can easily be accessed.

#### Controls **N/A**

- Optional integral passive infrared Bluetooth™ motion and photocell sensor. Fixtures operate independently and can be commissioned via iOS or Android configuration app.
- LSI's AirLink™ wireless control system options reduce energy and maintenance costs while optimizing light quality 24/7. (see page 8 for more details).

#### Installation

- Designed to mount to square or round poles.

- A single fastener secures the hinged door, underneath the housing and provides quick & easy access to the electrical compartment.
- Included terminal block (accepts up to 12 ga. wire) and 5' dimming and power leads extended to the housing exterior.
- Utilizes both B3 and B5 drill patterns for easy fastening of LSI products. (See drawing on page 8)

#### Warranty

- LSI luminaires carry a 5-year limited warranty. Refer to <https://www.lsiindustries.com/resources/terms-and-warranty.aspx> for more information.

#### Listings

- Listed to UL 1598 and UL 8750.
- Meets Buy American Act requirements.
- IDA compliant; with 3000K color temperature selection.
- Title 24 Compliant; see local ordinance for qualification information.
- Suitable for wet locations.
- IP66 rated Luminaire per IEC 60598-1.
- 3G rated for ANSI C136.31 high vibration applications applications are qualified.
- DesignLights Consortium® (DLC) qualified product. Not all versions of this product may be DLC qualified. Please check the DLC Qualified Products List at [www.designlights.org/QPL](http://www.designlights.org/QPL) to confirm which versions are qualified.
- Patented Silicone Optics (US Patent NO. 10,816,165 B2)





Type: \_\_\_\_\_

# ZONE Large Outdoor Sports Light

## ORDERING GUIDE

[Back to Quick Links](#)TYPICAL ORDER EXAMPLE: **ZNL 60L CT UNV 50 ALBCS1 BLK IH**

Prefix	Output	Distribution	Orientation	Voltage	Color Temperature
ZNL - Zone Large	50L - 50,000 lms 60L - 60,000 lms 65L - 65,000 lms 78L - 78,000 lms Custom Lumen Packages <sup>1</sup>	CT - Court Optic FT - Forward Throw	(Blank) - Standard (no rotation) L - Optics rotated left 90° R - Optics rotated right 90°	UNV - Universal Voltage (120-277V) HV - High Voltage (347 - 480V)	50 - 5,000 CCT 40 - 4,000 CCT 30 - 3,000 CCT

Controls	Finish	Options
<p>(Blank) - None</p> <p><b>Wireless Controls System - This Not Included</b></p> <p>ALSC - AirLink Synapse Control System ALSCS02 - AirLink Synapse Control System with 12-20' Motion Sensor ALSCS04 - AirLink Synapse Control System with 20-40' Motion Sensor ALBCS1 - AirLink Blue Wireless Motion &amp; Photo Sensor Controller (8-24' mounting height)<sup>2,3</sup> ALBCS2 - AirLink Blue Wireless Motion &amp; Photo Sensor Controller (25-40' mounting height)<sup>2,3</sup></p> <p><b>Stand-Alone Controls</b></p> <p>EXT - 0-10v Dimming leads extended to housing exterior CR7P - 7 Pin Control Receptacle ANSI C136.41<sup>5</sup> IMSBT1 - Integral Bluetooth™ Motion and Photocell Sensor max 8-24' mounting height<sup>3,4</sup> IMSBT2 - Integral Bluetooth Motion and Photocell Sensor max 25-40' mounting height<sup>3,4</sup></p>	<p>BRZ - Bronze BLK - Black GPT - Graphite MSV - Metallic Silver PLP - Platinum Plus GRN - Green WHT - White</p>	<p>(Blank) - None IH - Integral Houseside Shield IL - Integral Louver (Sharp Spill Light Cutoff) FMS - Fixed Mounting Studs<sup>9</sup></p>

### Accessory Ordering Information<sup>6</sup>

Controls Accessories <sup>6</sup>	
Description	Order Number
Twist Lock Photocell (120V) for use with CR7P	122514
Twist Lock Photocell (208-277) for use with CR7P	122515
Twist Lock Photocell (347V) for use with CR7P	122516
Twist Lock Photocell (480V) for use with CR7P	225180
AirLink 5 Pin Twist Lock Controller	61409
AirLink 7 Pin Twist Lock Controller	661410
Pole-Mounted Occupancy Sensor (24V)	663284CLR <sup>7</sup>
Shorting Cap for use with CR7P <sup>8</sup>	149328

Fusing Accessories <sup>8</sup>	
Description	Order Number
Single Fusing (120V)	FK120
Single Fusing (277V)	FK277
Double Fusing (480V)	DFK480
Double Fusing (347V)	DFK347

Mounting Accessories <sup>5</sup>	
Description	Order Number
Universal Mounting Bracket	684616CLR
Adjustable Slip Fitter (2" - 2 3/8" Tenon)	688138CLR
Quick Mount Pole Bracket (Square Pole)	687073CLR
Quick Mount Pole Bracket (4-5" Round Pole)	689903CLR
15 Tilt Quick Mount Pole Bracket (Square Pole)	688003CLR
15 Tilt Quick Mount Pole Bracket (4-5" Round Pole)	689905CLR
Wall Mount Bracket	382132CLR
ZNL Upswept Arm (Requires FMS Option)	756047CLR
Integral Louver/Shield	686485
Internal Houseside Shield	743416
10' Linear Bird Spike Kit (4' Recommended per Luminaire)	736795

#### FOOTNOTES:

1. Custom lumen and wattage packages available, consult factory. Values are within industry standard tolerances but not DLC listed.
2. Consult factory for site layout.
3. Consult factory for 347-480V.
4. IMSBT is field configurable via the LSI app that can be downloaded from your smartphone's native app store. Consult Factory for 347-480V.
5. Control device or shorting cap must be ordered separately. See Accessory Ordering Information.
6. Accessories are shipped separately and field installed.
7. "CLR" denotes finish. See Finish options.
8. Fusing must be located in hand hole of pole.
9. For use with ZNL upswept arm only. Please see accessory table for ordering details.





# ZONE Large Outdoor Sports Light

## OPTICS ROTATION

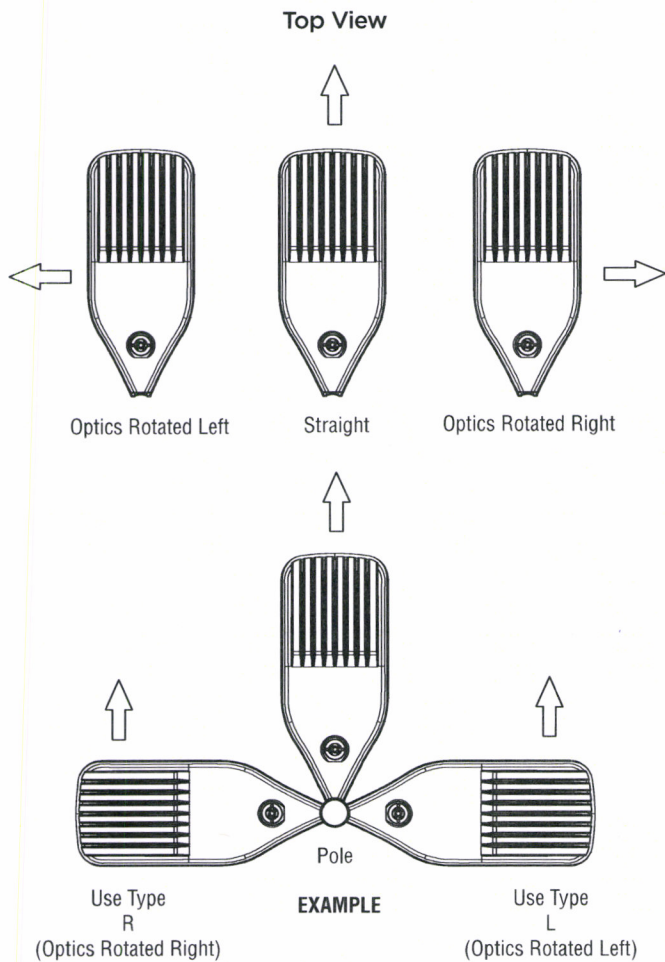

## ACCESSORIES/OPTIONS

### Integral Louver (IL) and House-Side Shield (IH)

Accessory louver and shield available for improved backlight control without sacrificing street side performance. LSI's Integral Louver (L) and Integral House-Side Shield (IH) options deliver backlight control that significantly reduces spill light behind the poles for applications with pole locations close to adjacent properties. The design maximizes forward reflected light while reducing glare, maintaining the optical distribution selected, and most importantly eliminating light trespass. Both options rotate with the optical distribution.

### Luminaire Shown with IMSBT & IL/IH Options

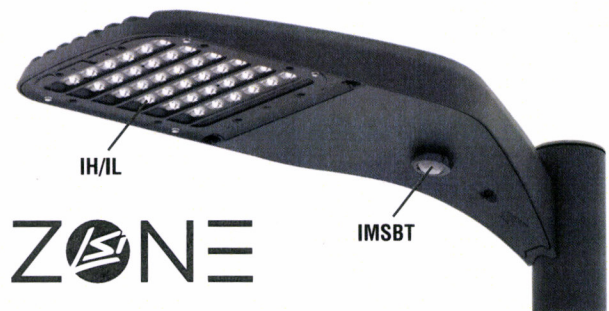

### 7 Pin Photoelectric Control

7-pin ANSI C136.41-2013 control receptacle option available for twist lock photocontrols or wireless control modules. Control accessories sold separately. Dimming leads from the receptacle will be connected to the driver dimming leads (Consult factory for alternate wiring).

### Luminaire Shown with PCR 7P

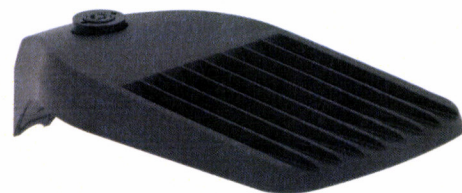



# ZONE Large Outdoor Sports Light

## PERFORMANCE

[Back to Quick Links](#)

DELIVERED LUMENS*												
Lumen Package	Distribution	CRI	3000K CCT			4000K CCT			5000K CCT			Wattage
			Delivered Lumens	Efficacy	BUG Rating	Delivered Lumens	Efficacy	BUG Rating	Delivered Lumens	Efficacy	BUG Rating	
50L	CT	70	50680	135	B4-U0-G3	52572	140	B4-U0-G3	64622	146	B4-U0-G3	375
	FT		50082	134	B4-U0-G5	51952	139	B4-U0-G5	53978	144	B4-U0-G5	
60L	CT		57428	128	B4-U0-G3	59446	133	B4-U0-G3	60978	133	B4-U0-G3	448
	FT		56949	127	B4-U0-G5	59083	132	B5-U0-G5	60561	135	B5-U0-G5	
65L	CT		65005	125	B4-U0-G3	67432	130	B5-U0-G3	70062	135	B5-U0-G3	518
	FT		64239	124	B5-U0-G5	66638	129	B5-U0-G5	69237	134	B5-U0-G5	
78L	CT		74805	115	B5-U0-G3	77599	120	B5-U0-G3	80625	124	B5-U0-G3	648
	FT		73925	114	B5-U0-G5	76685	118	B5-U0-G5	79676	123	B5-U0-G5	

\*LEDs are frequently updated therefore values are nominal

ELECTRICAL DATA* (AMPS)						
Lumen Package	120V	208V	240V	277V	347V	480V
50L	3.13	1.80	1.56	1.35	1.08	0.78
60L	3.73	2.15	1.87	1.62	1.29	0.93
65L	4.32	2.49	2.16	1.87	1.49	1.08
78L	5.40	3.12	2.70	2.34	1.87	1.35

\*Electrical data at 25C (77F). Actual wattage may differ by +/-10%.

RECOMMENDED LUMEN MAINTENANCE <sup>1</sup>					
Ambient Temp	Lumen Multiplier				
	0 hrs. (2)	25K hrs. (2)	50K hrs. (2)	75K hrs. (3)	100K hrs. (3)
0 C - 40 C	100%	100%	97%	94%	92%

**FOOTNOTES:**

- Lumen maintenance values at 25°C are calculated per TM-21 based on LM-80 data and in-situ luminaire testing.
- In accordance with IESNA TM-21-11, Projected Values represent interpolated value based on time durations that are within six times (6X) the IESNA LM-80-08 total test duration (in hours) for the device under testing ((DUT) i.e. the packaged LED chip).
- In accordance with IESNA TM-21-11, Calculated Values represent time durations that exceed six times NA LM-80-08 total test duration (in hours) for the device under testing ((DUT) i.e. the packaged LED chip).

## PHOTOMETRICS

[Back to Quick Links](#)

Luminaire photometry has been conducted by a NVLAP accredited testing laboratory in accordance with IESNA LM-79-08. As specified by IESNA LM-79-08 the entire luminaire is tested as the source resulting in a luminaire efficiency of 100%.

See <http://www.lsi-industries.com/products/led-lighting-solutions.aspx> for detailed photometric data.

### ZNL-60L-CT-40

#### LUMINAIRE DATA

Type 3 Distribution	
Description	4000 Kelvin, 70 CRI
Delivered Lumens	67,432
Watts	518
Efficacy	130
IES Type	Type III - Very Short
BUG Rating	B5-U0-G3

#### Zonal Lumen Summary

Zone	Lumens	%Luminaire
Low (0-30)°	13837	9%
Medium (30-60)°	44654	43%
High (60-80)°	8162	48%
Very High (80-90)°	779	1%
Uplight (90-180)°	0	0%
Total Flux	67432	100%

#### ISO FOOTCANDLE

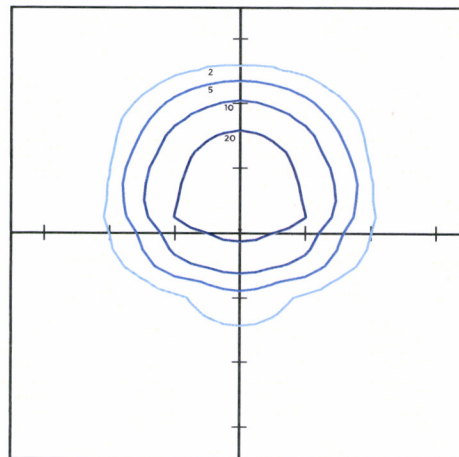

#### POLAR CURVE

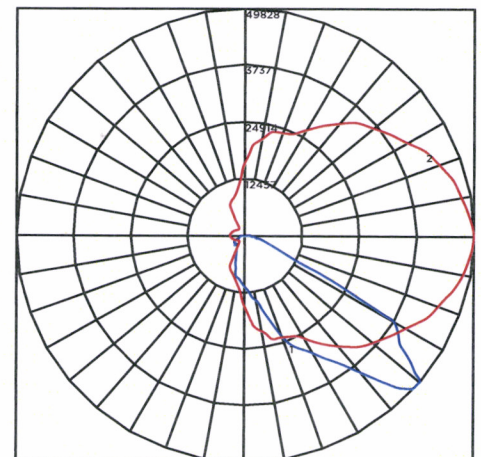

#### 25' Mounting Height/20' Grid Spacing

■ 20 FC ■ 10 FC ■ 5 FC ■ 2 FC





# ZONE Large Outdoor Sports Light

## PHOTOMETRICS

ZNL-65L-FT-40

### LUMINAIRE DATA

Type CT-IL Distribution	
Description	4000 Kelvin, 70 CRI
Delivered Lumens	66,638
Watts	518
Efficacy	129
IES Type	Type IV - Short
BUG Rating	B5-U0-G5

### Zonal Lumen Summary

Zone	Lumens	%Luminaire
Low (0-30)°	8542	13%
Medium (30-60)°	33055	50%
High (60-80)°	23973	36%
Very High (80-90)°	1069	2%
Uplight (90-180)°	0	0%
Total Flux	66638	100%

### ISO FOOTCANDLE

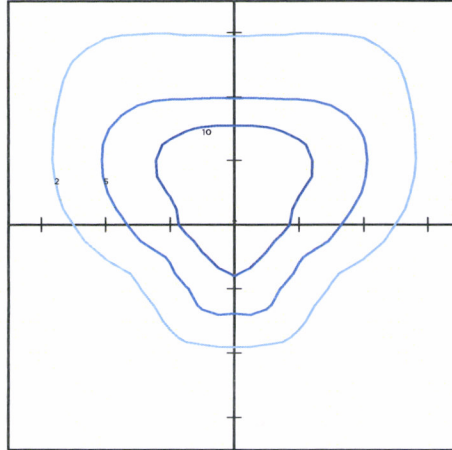

### POLAR CURVE

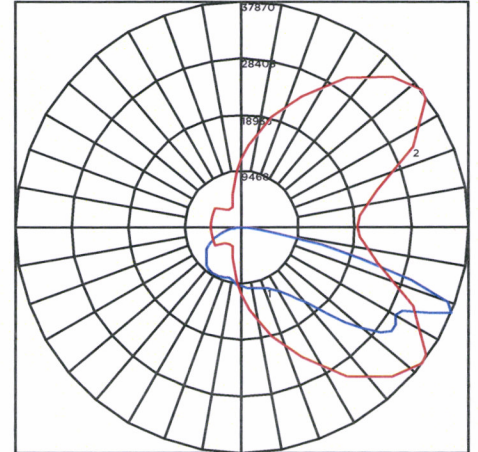

25' Mounting Height/20' Grid Spacing

20 FC
  10 FC
  5 FC
  2 FC





# ZONE Large Outdoor Sports Light

## ACCESSORIES/OPTIONS

### Integral Louver (IL) and House-Side Shield (IH)

Accessory louver and shield available for improved backlight control without sacrificing street side performance. LSI's Integral Louver (IL) and Integral House-Side Shield (IH) options deliver backlight control that significantly reduces spill light behind the poles for applications with pole locations close to adjacent properties. The design maximizes forward-reflected light while reducing glare, maintaining the optical distribution selected, and most importantly eliminating light trespass. Both options rotate with the optical distribution.

Luminaire Shown with Integral Louver (IL)

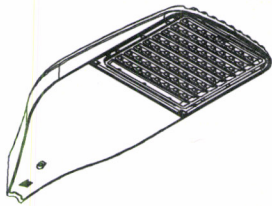

Luminaire Shown with IMSBT Option

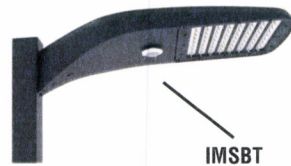

### 7 Pin Photoelectric Control

7-pin ANSI C136.41-2013 control receptacle option available for twist lock photocontrols or wireless control modules. Control accessories sold separately. Dimming leads from the receptacle will be connected to the driver dimming leads (Consult factory for alternate wiring).

Luminaire Shown with PCR 7P

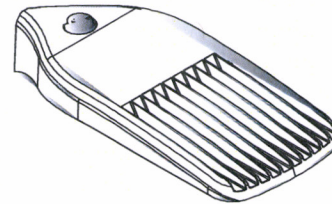

## PRODUCT DIMENSIONS

[Back to Quick Links](#)

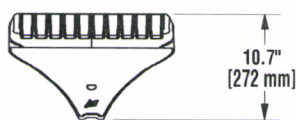
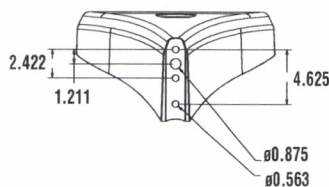
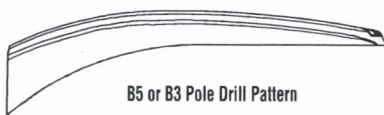
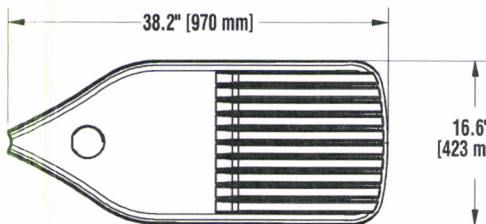

### LUMINAIRE EPA CHART - ZNL

Tilt Degree	0°	30°	45°	Tilt Degree	0°	30°	45°		
	Single	0.8	2.2	2.9		T90°	2.0	3.8	4.5
	D180°	1.6	2.2	2.9		TN120°	2.0	5.0	6.0
	D90°	1.2	3.0	3.7		Q90°	2.0	3.8	4.5

## BRACKETS

BKA-NM-\* -CLR: Tenon Mount Fitter

BRKT-4ESF-\* -CLR: Pole Top Hub

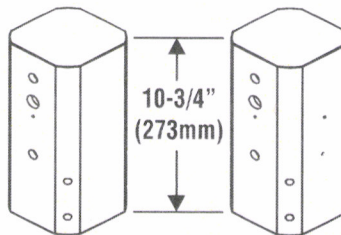

S/D-180 (Drilled 2 Sides)      D90/T90/Q90 (Drilled 4 Sides)  
For flat surface brackets



- S - Single
- D180 - Double
- D70 - Double
- D90 - Double
- Q90 - Quad
- Q90 - Quad

Fits over 4" OD pole or tenon





# ZONE Large Outdoor Sports Light

## CONTROLS

### AirLink Wireless Lighting Controller

The AirLink integrated controller is a California Title 24 compliant lighting controller that provides real-time light monitoring and control with utility-grade power monitoring. It includes a 24V sensor input and power supply to connect a sensor into the outdoor AirLink wireless lighting system. The wireless integrated controller is compatible with this fixture.

Click the link below to learn more details about AirLink.

<https://www.lsi-industries.com/documents/datasheets/airlink-outdoor-specsheet.pdf>

### Integral Bluetooth™ Motion and Photocell Sensor (IMSBT)

Slim low profile sensor provides multi-level control based on motion and/or daylight. Sensor controls 0-10 VDC LED drivers and is rated for cold and wet locations (-30° C to 70° C). Two unique PIR lenses are available and used based on fixture mounting height. All control parameters are adjustable via an iOS or Android App capable of storing and transmitting sensor profiles.

Click the link below to learn more details about IMSBT.

<https://www.lsi-industries.com/documents/datasheets/imsbt-specsheet.pdf>

### AirLink Blue

Wireless Bluetooth Mesh Outdoor Lighting Control System that provides energy savings, code compliance and enhanced safety/security for parking lots and parking garages. Three key components; Bluetooth wireless radio/sensor controller, Time Keeper and an iOS App. Capable of grouping multiple fixtures and sensors as well as scheduling time-based events by zone. Radio/Sensor Controller is factory integrated into Area/Site, Wall Mounted, Parking Garage and Canopy luminaires.

Click the link below to learn more details about AirLink Blue.

<https://www.lsi-airlink.com/airlink-blue/>

## POLES & BRACKETS

LSI offers a full line of poles and mounting accessories to complete your lighting assembly. Aluminum and steel in both square and round shafts. In addition, LSI offers round tapered, fluted and hinge based poles. Designed and engineered for durability and protected with our oven baked DuraGrip Protection System. Also available with our DuraGrip+ Protection system for unmatched corrosion resistance and an extended warranty. American made in our Ohio facility with industry leading lead times.

Click the link below to learn more details about poles & brackets.

<https://www.lsi-industries.com/products/poles-and-brackets-area-street.aspx>



#### BKA UMB CLR

The 3G rated UMB allows for seamless integration of LSI luminaires onto existing/ retrofit or new construction poles. The UMB was designed for square or round (tapered or straight) poles with two mounting hole spacings between 3.5" - 5".



#### BKA ASF CLR

The adjustable Slip Fitter is a 3G rated rugged die cast aluminum adapter to mount LSI luminaires onto a 2" iron pipe, 2 3/8 OD tenon. The Adjustable Slip Fitter can be rotated 180° allowing for tilting LSI luminaires up to 45° and 90° when using a vertical tenon.



#### BKS PQM15 CLR

The Pole Quick Mount Bracket allows for preset 15° uptilt of LSI luminaires for greater throw of light and increased vertical illumination as well as fast installation onto poles with LSI's 3" or 5" bolt pattern.



#### BKS PQMH CLR

The Pole Quick Mount Bracket allows for lightning fast installation of LSI luminaires onto existing and new construction poles with LSI's B3 or B5 standard pole bolt patterns.

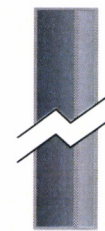

Square Pole  
14'-39'



Round Pole  
10'-30'

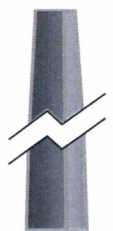

Tapered Pole  
20'-39'

