



“RE-BUILDING THE CITY’S WATER SYSTEMS FOR THE 21<sup>ST</sup> CENTURY”

# Sewerage & Water Board OF NEW ORLEANS

625 ST. JOSEPH STREET  
NEW ORLEANS, LA 70165 • 504-529-2837 OR 52-WATER  
[www.swbno.org](http://www.swbno.org)

## Addendum No. 2

Date: 3/20/2024

Your reference is directed to **Contract Number: 2024-SWB-12 (30261)** for **Carrollton Basin Sewer Rehabilitation No. 20** which is scheduled to open at **11:30 a.m. CDT** on **April 22, 2024**, for SWBNO Engineering Department.

This addendum provides for the following:

1. Revisions to Specifications below.
  - a. Section 00 41 13 Uniform Public Bid Form, **REPLACE** with updated version included herein.
  - b. Section 00 22 00 Unit Prices, **REPLACE** with updated version included herein.
2. Revisions to Plans Below.
  - a. Sheet 3 Estimated Bid Quantities, **REPLACE** with updated version included herein.
  - b. ADD Sheet 28 and 29, drawings for 2600 S. Carrollton included herein.
3. The revised deadline for inquiries.
  - a. April 15, 2024, by 5:00 p.m. (CDT).

The above revisions shall be incorporated in and take precedence over any conflicting part of the original proposal documents. This addendum is hereby officially made a part of the referenced proposal.

Receipt of this addendum shall be acknowledged by inserting its number and date in the space provided on the Louisiana Uniform Public Works Bid Form.

This addendum consists of one (1) page with twenty-six (26) pages of attachments.

\*\*\* END OF ADDENDUM \*\*\*

## 30261 - CARROLLTON BASIN SEWER REHABILITATION NO. 20

### Addendum Number 2

**Date: 3/19/2024**

Your reference is directed to Contract Number: 30261 for Carrollton Basin Sewer Rehabilitation No. 20 which is due 11:00 a.m. CST on April 22, 2024. All inquiries shall be directed to Kimberly Barnes, Procurement Analyst, at [kbarnes@swbno.org](mailto:kbarnes@swbno.org). The deadline for inquiries is on April 15, 2024, at 5:00 p.m. Central Time.

The addendum provides for the following:

1. Revisions to Specifications below.
  - a. Section 00 41 13 Uniform Public Bid Form, **REPLACE** with updated version included herein.
  - b. Section 00 22 00 Unit Prices, **REPLACE** with updated version included herein.
  
2. Revisions to Plans Below.
  - a. Sheet 3 Estimated Bid Quantities, **REPLACE** with updated version included herein.
  - b. **ADD** Sheet 28 and 29, drawings for 2600 S Carrollton included herein.

This addendum consists of one (1) page, with twenty-six (26) pages of attachments.

This addendum shall be part of the Contract Documents as provided in the instructions to Bidders. Items herein are issued to add to, modify, and clarify the Contract Documents. These items shall have full force and effect as the Contract Documents, and the cost involved shall be included in the bid prices. Acknowledge receipt of the addendum by inserting its number on the Bid Form of the Bid Documents. Failure to do so will subject the bidder to rejection.

\*\*\* END OF ADDENDUM \*\*\*

LOUISIANA UNIFORM PUBLIC WORK BID FORM

TO: Sewerage and Water Board of New Orleans
Purchasing Department, Room 133
625 St. Joseph St
New Orleans, LA 70165

BID FOR: Contract 30261
Carrollton Sewer Rehabilitation No. 20

The undersigned bidder hereby declares and represents that she/he; a) has carefully examined and understands the Bidding Documents, b) has not received, relied on, or based his bid on any verbal instructions contrary to the Bidding Documents or any addenda, c) has personally inspected and is familiar with the project site, and hereby proposes to provide all labor, materials, tools, appliances and facilities as required to perform, in a workmanlike manner, all work and services for the construction and completion of the referenced project, all in strict accordance with the Bidding Documents prepared by: Stantec Consulting Services Inc. and dated: February 19, 2024

Bidders must acknowledge all addenda. The Bidder acknowledges receipt of the following ADDENDA: (Enter the number the Designer has assigned to each of the addenda that the Bidder is acknowledging)

\_\_\_\_\_ .

TOTAL BASE BID: For all work required by the Bidding Documents (including any and all unit prices designated "Base Bid" \* but not alternates) the sum of:

\_\_\_\_\_ Dollars (\$ \_\_\_\_\_)

ALTERNATES: For any and all work required by the Bidding Documents for Alternates including any and all unit prices designated as alternates in the unit price description.

NOTE TO BIDDERS: (Insert Applicable Notes if Alternates are required)

NAME OF BIDDER: \_\_\_\_\_

ADDRESS OF BIDDER: \_\_\_\_\_

LOUISIANA CONTRACTOR'S LICENSE NUMBER: \_\_\_\_\_

NAME OF AUTHORIZED SIGNATORY OF BIDDER: \_\_\_\_\_

TITLE OF AUTHORIZED SIGNATORY OF BIDDER: \_\_\_\_\_

SIGNATURE OF AUTHORIZED SIGNATORY OF BIDDER \*\*: \_\_\_\_\_

DATE: \_\_\_\_\_

\* The Unit Price Form shall be used if the contract includes unit prices. Otherwise it is not required and need not be included with the form. The number of unit prices that may be included is not limited and additional sheets may be included if needed.

\*\* If someone other than a corporate officer signs for the Bidder/Contractor, a copy of a corporate resolution or other signature authorization shall be required for submission of bid. Failure to include a copy of the appropriate signature authorization, if required, may result in the rejection of the bid unless bidder has complied with La. R.S. 38:2212(A)(1)(c) or RS 38:2212(O) .

BID SECURITY in the form of a bid bond, certified check or cashier's check as prescribed by LA RS 38:2218.A is attached to and made a part of this bid

# LOUISIANA UNIFORM PUBLIC WORK BID FORM

## UNIT PRICE FORM

**TO:** Sewerage and Water Board of New Orleans  
Purchasing Department, Rm 133  
625 St. Joseph St  
New Orleans, LA 70165

**BID FOR:** Contract 30261  
Carrollton Sewer  
Rehabilitation No. 20

**UNIT PRICES:** This form shall be used for any and all work required by the Bidding Documents and described as unit prices. Amounts shall be stated in figures and only in figures.

DESCRIPTION:	<input checked="" type="checkbox"/> Base Bid or <input type="checkbox"/> Alt.# ___ Removal and Disposal of Existing Portland Cement Concrete Pavement			
REF. NO.	QUANTITY:	UNIT OF MEASURE:	UNIT PRICE	UNIT PRICE EXTENSION ( <i>Quantity times Unit Price</i> )
1	545	SY		

DESCRIPTION:	<input checked="" type="checkbox"/> Base Bid or <input type="checkbox"/> Alt.# ___ Removal and Disposal of Existing Sidewalk, Driveway, Foot Lap (Concrete, Brick, Asphalt, or etc.)			
REF. NO.	QUANTITY:	UNIT OF MEASURE:	UNIT PRICE	UNIT PRICE EXTENSION ( <i>Quantity times Unit Price</i> )
2	1,132	SY		

DESCRIPTION:	<input checked="" type="checkbox"/> Base Bid or <input type="checkbox"/> Alt.# ___ Removal and Disposal of Existing Curb (Concrete, Asphalt, Brick, etc.)			
REF. NO.	QUANTITY:	UNIT OF MEASURE:	UNIT PRICE	UNIT PRICE EXTENSION ( <i>Quantity times Unit Price</i> )
3	75	LF		

DESCRIPTION:	<input checked="" type="checkbox"/> Base Bid or <input type="checkbox"/> Alt.# ___ Removal and Disposal of Existing Curb and Gutter Bottom			
REF. NO.	QUANTITY:	UNIT OF MEASURE:	UNIT PRICE	UNIT PRICE EXTENSION ( <i>Quantity times Unit Price</i> )
4	3,825	LF		

DESCRIPTION:	<input checked="" type="checkbox"/> Base Bid or <input type="checkbox"/> Alt.# ___ Removal and Disposal of Existing Asphaltic Concrete Pavement			
REF. NO.	QUANTITY:	UNIT OF MEASURE:	UNIT PRICE	UNIT PRICE EXTENSION ( <i>Quantity times Unit Price</i> )
5	4,632	SY		

DESCRIPTION:	<input checked="" type="checkbox"/> Base Bid or <input type="checkbox"/> Alt.# ___ Roadway Excavation			
REF. NO.	QUANTITY:	UNIT OF MEASURE:	UNIT PRICE	UNIT PRICE EXTENSION ( <i>Quantity times Unit Price</i> )
6	1,226	CY		

DESCRIPTION:	<input checked="" type="checkbox"/> Base Bid or <input type="checkbox"/> Alt.# ___ Unsuitable Subgrade Excavation and Sand Filling			
REF. NO.	QUANTITY:	UNIT OF MEASURE:	UNIT PRICE	UNIT PRICE EXTENSION ( <i>Quantity times Unit Price</i> )
7	335	CY		

DESCRIPTION:	<input checked="" type="checkbox"/> Base Bid or <input type="checkbox"/> Alt.# ___ Geotextile Fabric for Stabilization			
REF. NO.	QUANTITY:	UNIT OF MEASURE:	UNIT PRICE	UNIT PRICE EXTENSION ( <i>Quantity times Unit Price</i> )
8	10,946	SY		

DESCRIPTION:	<input checked="" type="checkbox"/> Base Bid or <input type="checkbox"/> Alt.# ___ Geogrid			
REF. NO.	QUANTITY:	UNIT OF MEASURE:	UNIT PRICE	UNIT PRICE EXTENSION ( <i>Quantity times Unit Price</i> )
9	4,903	SY		

DESCRIPTION:	<input checked="" type="checkbox"/> Base Bid or <input type="checkbox"/> Alt.# ___ Base Course			
REF. NO.	QUANTITY:	UNIT OF MEASURE:	UNIT PRICE	UNIT PRICE EXTENSION ( <i>Quantity times Unit Price</i> )
10	1,197	CY		

DESCRIPTION:	<input checked="" type="checkbox"/> Base Bid or <input type="checkbox"/> Alt.# ___ Superpave Asphaltic Concrete Binder Course For Composite Roadways			
REF. NO.	QUANTITY:	UNIT OF MEASURE:	UNIT PRICE	UNIT PRICE EXTENSION ( <i>Quantity times Unit Price</i> )
11	87	TON		

DESCRIPTION:	<input checked="" type="checkbox"/> Base Bid or <input type="checkbox"/> Alt.# ___ Superpave Asphaltic Concrete Wearing Course (2.5" Thick)			
REF. NO.	QUANTITY:	UNIT OF MEASURE:	UNIT PRICE	UNIT PRICE EXTENSION ( <i>Quantity times Unit Price</i> )
12	14,138	SY		

DESCRIPTION:	<input checked="" type="checkbox"/> Base Bid or <input type="checkbox"/> Alt.# ___ Superpave Asphaltic Concrete Binder Course (4.5" Thick)			
REF. NO.	QUANTITY:	UNIT OF MEASURE:	UNIT PRICE	UNIT PRICE EXTENSION ( <i>Quantity times Unit Price</i> )
13	4,474	SY		

DESCRIPTION:	<input checked="" type="checkbox"/> Base Bid or <input type="checkbox"/> Alt.# ___ Cold Planning Asphaltic Pavement (2" Average Thick)			
REF. NO.	QUANTITY:	UNIT OF MEASURE:	UNIT PRICE	UNIT PRICE EXTENSION ( <i>Quantity times Unit Price</i> )
14	13,956	SY		

DESCRIPTION:	<input checked="" type="checkbox"/> Base Bid or <input type="checkbox"/> Alt.# ___ Reinforced Concrete Pavement (8" Thick)			
REF. NO.	QUANTITY:	UNIT OF MEASURE:	UNIT PRICE	UNIT PRICE EXTENSION ( <i>Quantity times Unit Price</i> )
15	300	SY		

DESCRIPTION:	<input checked="" type="checkbox"/> Base Bid or <input type="checkbox"/> Alt.# ___ Concrete Sidewalk (4" Thick)			
REF. NO.	QUANTITY:	UNIT OF MEASURE:	UNIT PRICE	UNIT PRICE EXTENSION ( <i>Quantity times Unit Price</i> )
16	883	SY		

DESCRIPTION:	<input checked="" type="checkbox"/> Base Bid or <input type="checkbox"/> Alt.# ___ Concrete Driveway (6" Thick)			
REF. NO.	QUANTITY:	UNIT OF MEASURE:	UNIT PRICE	UNIT PRICE EXTENSION ( <i>Quantity times Unit Price</i> )
17	249	SY		

DESCRIPTION:	<input checked="" type="checkbox"/> Base Bid or <input type="checkbox"/> Alt.# ___ 6" Concrete Barrier Curb With Dowels			
REF. NO.	QUANTITY:	UNIT OF MEASURE:	UNIT PRICE	UNIT PRICE EXTENSION ( <i>Quantity times Unit Price</i> )
18	3,876	LF		

DESCRIPTION:	<input checked="" type="checkbox"/> Base Bid or <input type="checkbox"/> Alt.# ___ Concrete Mountable Curb and Gutter Bottom or Rolling Strip			
REF. NO.	QUANTITY:	UNIT OF MEASURE:	UNIT PRICE	UNIT PRICE EXTENSION ( <i>Quantity times Unit Price</i> )
19	24	LF		

DESCRIPTION:	<input checked="" type="checkbox"/> Base Bid or <input type="checkbox"/> Alt.# ___ 6" Concrete Barrier Curb & Gutter Bottom Or Rolling Strip			
REF. NO.	QUANTITY:	UNIT OF MEASURE:	UNIT PRICE	UNIT PRICE EXTENSION ( <i>Quantity times Unit Price</i> )
20	10	LF		

DESCRIPTION:	<input checked="" type="checkbox"/> Base Bid or <input type="checkbox"/> Alt.# ___ Sodding			
REF. NO.	QUANTITY:	UNIT OF MEASURE:	UNIT PRICE	UNIT PRICE EXTENSION ( <i>Quantity times Unit Price</i> )
21	541	SY		

DESCRIPTION:	<input checked="" type="checkbox"/> Base Bid or <input type="checkbox"/> Alt.# ___ Saw Cut Concrete Curb, Pavement, Sidewalk, Driveway, etc. According to Plans ("Depth)			
REF. NO.	QUANTITY:	UNIT OF MEASURE:	UNIT PRICE	UNIT PRICE EXTENSION ( <i>Quantity times Unit Price</i> )
22	409	LF		

DESCRIPTION:	<input checked="" type="checkbox"/> Base Bid or <input type="checkbox"/> Alt.# ___ Saw Cut, Wheel Cut or Spade Cut Existing Asphalt, According to Plans			
REF. NO.	QUANTITY:	UNIT OF MEASURE:	UNIT PRICE	UNIT PRICE EXTENSION ( <i>Quantity times Unit Price</i> )
23	9,117	LF		

DESCRIPTION:	<input checked="" type="checkbox"/> Base Bid or <input type="checkbox"/> Alt.# ___ Remove of Handicap Ramps, Curb and Gutter, and Concrete Sidewalks at Intersections, including Saw Cutting			
REF. NO.	QUANTITY:	UNIT OF MEASURE:	UNIT PRICE	UNIT PRICE EXTENSION ( <i>Quantity times Unit Price</i> )
24	447	SY		

DESCRIPTION:	<input checked="" type="checkbox"/> Base Bid or <input type="checkbox"/> Alt.# ___ Handicap Ramps, Curb and Gutter, and Concrete Sidewalks at Intersections			
REF. NO.	QUANTITY:	UNIT OF MEASURE:	UNIT PRICE	UNIT PRICE EXTENSION ( <i>Quantity times Unit Price</i> )
25	447	SY		

DESCRIPTION:	<input checked="" type="checkbox"/> Base Bid or <input type="checkbox"/> Alt.# ___ Sidewalk Transition Adjacent to Handicap Ramps			
REF. NO.	QUANTITY:	UNIT OF MEASURE:	UNIT PRICE	UNIT PRICE EXTENSION ( <i>Quantity times Unit Price</i> )
26	429	SY		

DESCRIPTION:	<input checked="" type="checkbox"/> Base Bid or <input type="checkbox"/> Alt.# ___ Manhole Cover			
REF. NO.	QUANTITY:	UNIT OF MEASURE:	UNIT PRICE	UNIT PRICE EXTENSION ( <i>Quantity times Unit Price</i> )
27	20	EA		

DESCRIPTION:	<input checked="" type="checkbox"/> Base Bid or <input type="checkbox"/> Alt.# ___ Manhole Frame			
REF. NO.	QUANTITY:	UNIT OF MEASURE:	UNIT PRICE	UNIT PRICE EXTENSION ( <i>Quantity times Unit Price</i> )
28	20	EA		

DESCRIPTION:	<input type="checkbox"/> Base Bid or <input type="checkbox"/> Alt.# ___ Install Sewer Main (6" at 0' – 6.0')			
REF. NO.	QUANTITY:	UNIT OF MEASURE:	UNIT PRICE	UNIT PRICE EXTENSION ( <i>Quantity times Unit Price</i> )
29	275	LF		

DESCRIPTION:	<input type="checkbox"/> Base Bid or <input type="checkbox"/> Alt.# ___ Install Sewer Main (8" at 0' – 6.0')			
REF. NO.	QUANTITY:	UNIT OF MEASURE:	UNIT PRICE	UNIT PRICE EXTENSION ( <i>Quantity times Unit Price</i> )
30	2,073	LF		

DESCRIPTION:	<input checked="" type="checkbox"/> Base Bid or <input type="checkbox"/> Alt.# ___ Install Sewer Main (8" at 6.1' – 8.0')			
REF. NO.	QUANTITY:	UNIT OF MEASURE:	UNIT PRICE	UNIT PRICE EXTENSION ( <i>Quantity times Unit Price</i> )
31	450	LF		

DESCRIPTION:	<input checked="" type="checkbox"/> Base Bid or <input type="checkbox"/> Alt.# ___ Install Sewer Main (8" at 8.1' – 10.0')			
REF. NO.	QUANTITY:	UNIT OF MEASURE:	UNIT PRICE	UNIT PRICE EXTENSION ( <i>Quantity times Unit Price</i> )
32	1,026	LF		

DESCRIPTION:	<input checked="" type="checkbox"/> Base Bid or <input type="checkbox"/> Alt.# ___ Install Sewer Main (36" At 14.1' – 16.0')			
REF. NO.	QUANTITY:	UNIT OF MEASURE:	UNIT PRICE	UNIT PRICE EXTENSION ( <i>Quantity times Unit Price</i> )
33	51	LF		

DESCRIPTION:	<input checked="" type="checkbox"/> Base Bid or <input type="checkbox"/> Alt.# ___ Install Sewer Mains by Pipe Bursting (27" HDPE, DR11)			
REF. NO.	QUANTITY:	UNIT OF MEASURE:	UNIT PRICE	UNIT PRICE EXTENSION ( <i>Quantity times Unit Price</i> )
34	466	LF		

DESCRIPTION:	<input checked="" type="checkbox"/> Base Bid Or <input type="checkbox"/> Alt.# ___ Replace Exist. Sewer H.C. From New Main to Back of Curb			
REF. NO.	QUANTITY:	UNIT OF MEASURE:	UNIT PRICE	UNIT PRICE EXTENSION ( <i>Quantity times Unit Price</i> )
35	100	EA		

DESCRIPTION:	<input checked="" type="checkbox"/> Base Bid or <input type="checkbox"/> Alt.# ___ Replace Exist. Sewer H.C. Beyond Back of Curb			
REF. NO.	QUANTITY:	UNIT OF MEASURE:	UNIT PRICE	UNIT PRICE EXTENSION ( <i>Quantity times Unit Price</i> )
36	1,135	LF		

DESCRIPTION:	<input checked="" type="checkbox"/> Base Bid or <input type="checkbox"/> Alt.# ___ Install 6" Sewer Cleanout			
REF. NO.	QUANTITY:	UNIT OF MEASURE:	UNIT PRICE	UNIT PRICE EXTENSION ( <i>Quantity times Unit Price</i> )
37	2	EA		

DESCRIPTION:	<input checked="" type="checkbox"/> Base Bid or <input type="checkbox"/> Alt.# ___ Install Sewer Manhole			
REF. NO.	QUANTITY:	UNIT OF MEASURE:	UNIT PRICE	UNIT PRICE EXTENSION ( <i>Quantity times Unit Price</i> )
38	140	VF		

DESCRIPTION:	<input checked="" type="checkbox"/> Base Bid or <input type="checkbox"/> Alt.# ___ Pipe Liner (8")			
REF. NO.	QUANTITY:	UNIT OF MEASURE:	UNIT PRICE	UNIT PRICE EXTENSION ( <i>Quantity times Unit Price</i> )
39	255	LF		

DESCRIPTION:	<input checked="" type="checkbox"/> Base Bid or <input type="checkbox"/> Alt.# ___ Pipe Liner (10")			
REF. NO.	QUANTITY:	UNIT OF MEASURE:	UNIT PRICE	UNIT PRICE EXTENSION ( <i>Quantity times Unit Price</i> )
40	736	LF		

DESCRIPTION:	<input checked="" type="checkbox"/> Base Bid or <input type="checkbox"/> Alt.# ___ Pipe Liner (12")			
REF. NO.	QUANTITY:	UNIT OF MEASURE:	UNIT PRICE	UNIT PRICE EXTENSION ( <i>Quantity times Unit Price</i> )
41	331	LF		

DESCRIPTION:	<input checked="" type="checkbox"/> Base Bid or <input type="checkbox"/> Alt.# ___ Pipe Liner (CIPP, 15")			
REF. NO.	QUANTITY:	UNIT OF MEASURE:	UNIT PRICE	UNIT PRICE EXTENSION ( <i>Quantity times Unit Price</i> )
42	347	LF		

DESCRIPTION:	<input checked="" type="checkbox"/> Base Bid or <input type="checkbox"/> Alt.# ___ Pipe Liner (CIPP, 18")			
REF. NO.	QUANTITY:	UNIT OF MEASURE:	UNIT PRICE	UNIT PRICE EXTENSION ( <i>Quantity times Unit Price</i> )
43	351	LF		

DESCRIPTION:	<input checked="" type="checkbox"/> Base Bid or <input type="checkbox"/> Alt.# ___ Pipe Liner (CIPP, 21")			
REF. NO.	QUANTITY:	UNIT OF MEASURE:	UNIT PRICE	UNIT PRICE EXTENSION ( <i>Quantity times Unit Price</i> )
44	360	LF		

DESCRIPTION:	<input checked="" type="checkbox"/> Base Bid or <input type="checkbox"/> Alt.# ___ Pipe Liner (CIPP, 27")			
REF. NO.	QUANTITY:	UNIT OF MEASURE:	UNIT PRICE	UNIT PRICE EXTENSION ( <i>Quantity times Unit Price</i> )
45	1,955	LF		

DESCRIPTION:	<input checked="" type="checkbox"/> Base Bid or <input type="checkbox"/> Alt.# ___ Pipe Liner (CIPP, 36")			
REF. NO.	QUANTITY:	UNIT OF MEASURE:	UNIT PRICE	UNIT PRICE EXTENSION ( <i>Quantity times Unit Price</i> )
46	550	LF		

DESCRIPTION:	<input checked="" type="checkbox"/> Base Bid or <input type="checkbox"/> Alt.# ___ Cut Liner to Restore Existing Sewer House Connection (6", CIPP)			
REF. NO.	QUANTITY:	UNIT OF MEASURE:	UNIT PRICE	UNIT PRICE EXTENSION ( <i>Quantity times Unit Price</i> )
47	65	EA		

DESCRIPTION:	<input checked="" type="checkbox"/> Base Bid or <input type="checkbox"/> Alt.# ___ Sewer Point Repair Up To 12 Feet (8" At 8.1' - 10.0')			
REF. NO.	QUANTITY:	UNIT OF MEASURE:	UNIT PRICE	UNIT PRICE EXTENSION ( <i>Quantity times Unit Price</i> )
48	7	EA		

DESCRIPTION:	<input checked="" type="checkbox"/> Base Bid or <input type="checkbox"/> Alt.# ___ Sewer Point Repair Up To 12 Feet (10" At 10.1' - 12.0')			
REF. NO.	QUANTITY:	UNIT OF MEASURE:	UNIT PRICE	UNIT PRICE EXTENSION ( <i>Quantity times Unit Price</i> )
49	10	EA		

DESCRIPTION:	<input checked="" type="checkbox"/> Base Bid or <input type="checkbox"/> Alt.# ___ Sewer Point Repair Up To 12 Feet (12" At 10.1' - 12.0')			
REF. NO.	QUANTITY:	UNIT OF MEASURE:	UNIT PRICE	UNIT PRICE EXTENSION ( <i>Quantity times Unit Price</i> )
50	7	EA		

DESCRIPTION:	<input checked="" type="checkbox"/> Base Bid or <input type="checkbox"/> Alt.# ___ Sewer Point Repair Up To 12 Feet (18" At 14.1' - 16.0')			
REF. NO.	QUANTITY:	UNIT OF MEASURE:	UNIT PRICE	UNIT PRICE EXTENSION ( <i>Quantity times Unit Price</i> )
51	8	EA		

DESCRIPTION:	<input checked="" type="checkbox"/> Base Bid or <input type="checkbox"/> Alt.# ___ Sewer Point Repair Up To 12 Feet (21" At 14.1' - 16.0')			
REF. NO.	QUANTITY:	UNIT OF MEASURE:	UNIT PRICE	UNIT PRICE EXTENSION ( <i>Quantity times Unit Price</i> )
52	8	EA		

DESCRIPTION:	<input checked="" type="checkbox"/> Base Bid or <input type="checkbox"/> Alt.# ___ Sewer Point Repair Up To 12 Feet (27" At 10.1' - 12.0')			
REF. NO.	QUANTITY:	UNIT OF MEASURE:	UNIT PRICE	UNIT PRICE EXTENSION ( <i>Quantity times Unit Price</i> )
53	7	EA		

DESCRIPTION:	<input checked="" type="checkbox"/> Base Bid or <input type="checkbox"/> Alt.# ___ Sewer Point Repair Up To 12 Feet (27" At 12.1' - 14.0')			
REF. NO.	QUANTITY:	UNIT OF MEASURE:	UNIT PRICE	UNIT PRICE EXTENSION ( <i>Quantity times Unit Price</i> )
54	7	LF		

DESCRIPTION:	<input checked="" type="checkbox"/> Base Bid or <input type="checkbox"/> Alt.# ___ Sewer Point Repair Up To 12 Feet (36" At 14.1' - 16.0')			
REF. NO.	QUANTITY:	UNIT OF MEASURE:	UNIT PRICE	UNIT PRICE EXTENSION ( <i>Quantity times Unit Price</i> )
55	10	EA		

DESCRIPTION:	<input checked="" type="checkbox"/> Base Bid or <input type="checkbox"/> Alt.# ___ Sewer Point Repair Beyond 12 Feet (10" At 10.1' - 12.0')			
REF. NO.	QUANTITY:	UNIT OF MEASURE:	UNIT PRICE	UNIT PRICE EXTENSION ( <i>Quantity times Unit Price</i> )
56	5	LF		

DESCRIPTION:	<input checked="" type="checkbox"/> Base Bid or <input type="checkbox"/> Alt.# ___ Sewer Point Repair Beyond 12 Feet (12" At 10.1' - 12.0')			
REF. NO.	QUANTITY:	UNIT OF MEASURE:	UNIT PRICE	UNIT PRICE EXTENSION ( <i>Quantity times Unit Price</i> )
57	5	LF		

DESCRIPTION:	<input checked="" type="checkbox"/> Base Bid or <input type="checkbox"/> Alt.# ___ Sewer Point Repair Beyond 12 Feet (18" At 14.1' - 16.0')			
REF. NO.	QUANTITY:	UNIT OF MEASURE:	UNIT PRICE	UNIT PRICE EXTENSION ( <i>Quantity times Unit Price</i> )
58	25	LF		

DESCRIPTION:	<input checked="" type="checkbox"/> Base Bid or <input type="checkbox"/> Alt.# ___ Sewer Point Repair Beyond 12 Feet (21" At 14.1' - 16.0')			
REF. NO.	QUANTITY:	UNIT OF MEASURE:	UNIT PRICE	UNIT PRICE EXTENSION ( <i>Quantity times Unit Price</i> )
59	11	LF		



DESCRIPTION:	<input checked="" type="checkbox"/> Base Bid or <input type="checkbox"/> Alt.# ___ Sewer Point Repair Beyond 12 Feet (27" At 10.1' - 12.0')			
REF. NO.	QUANTITY:	UNIT OF MEASURE:	UNIT PRICE	UNIT PRICE EXTENSION ( <i>Quantity times Unit Price</i> )
60	31	LF		

DESCRIPTION:	<input checked="" type="checkbox"/> Base Bid or <input type="checkbox"/> Alt.# ___ Sewer Point Repair Beyond 12 Feet (27" At 12.1' - 14.0')			
REF. NO.	QUANTITY:	UNIT OF MEASURE:	UNIT PRICE	UNIT PRICE EXTENSION ( <i>Quantity times Unit Price</i> )
61	13	LF		

DESCRIPTION:	<input checked="" type="checkbox"/> Base Bid or <input type="checkbox"/> Alt.# ___ Sewer Point Repair Beyond 12 Feet (36" At 14.1' - 16.0')			
REF. NO.	QUANTITY:	UNIT OF MEASURE:	UNIT PRICE	UNIT PRICE EXTENSION ( <i>Quantity times Unit Price</i> )
62	39	LF		

DESCRIPTION:	<input checked="" type="checkbox"/> Base Bid or <input type="checkbox"/> Alt.# ___ Sewer Main Line Cleaning (8"-14")			
REF. NO.	QUANTITY:	UNIT OF MEASURE:	UNIT PRICE	UNIT PRICE EXTENSION ( <i>Quantity times Unit Price</i> )
63	2,829	LF		

DESCRIPTION:	<input checked="" type="checkbox"/> Base Bid or <input type="checkbox"/> Alt.# ___ Sewer Main Line Cleaning (15" – 21")			
REF. NO.	QUANTITY:	UNIT OF MEASURE:	UNIT PRICE	UNIT PRICE EXTENSION ( <i>Quantity times Unit Price</i> )
64	698	LF		

DESCRIPTION:	<input checked="" type="checkbox"/> Base Bid or <input type="checkbox"/> Alt.# ___ Sewer Main Line Cleaning (24" – 27")			
REF. NO.	QUANTITY:	UNIT OF MEASURE:	UNIT PRICE	UNIT PRICE EXTENSION ( <i>Quantity times Unit Price</i> )
65	1,955	LF		

DESCRIPTION:	<input checked="" type="checkbox"/> Base Bid or <input type="checkbox"/> Alt.# ___ Sewer Main Line Cleaning (33" – 36")			
REF. NO.	QUANTITY:	UNIT OF MEASURE:	UNIT PRICE	UNIT PRICE EXTENSION ( <i>Quantity times Unit Price</i> )
66	550	LF		

DESCRIPTION:	<input checked="" type="checkbox"/> Base Bid or <input type="checkbox"/> Alt.# ___ Sewer Main Line CCTV Inspection			
REF. NO.	QUANTITY:	UNIT OF MEASURE:	UNIT PRICE	UNIT PRICE EXTENSION ( <i>Quantity times Unit Price</i> )
67	4,563	LF		

DESCRIPTION:	<input checked="" type="checkbox"/> Base Bid or <input type="checkbox"/> Alt.# ___ Sewer Service Lateral Lining (6" CIPP)			
REF. NO.	QUANTITY:	UNIT OF MEASURE:	UNIT PRICE	UNIT PRICE EXTENSION ( <i>Quantity times Unit Price</i> )
68	65	EA		

DESCRIPTION:	<input checked="" type="checkbox"/> Base Bid or <input type="checkbox"/> Alt.# ___ Sanitary Sewer Service Lateral CCTV Inspection			
REF. NO.	QUANTITY:	UNIT OF MEASURE:	UNIT PRICE	UNIT PRICE EXTENSION ( <i>Quantity times Unit Price</i> )
69	65	EA		

DESCRIPTION:	<input checked="" type="checkbox"/> Base Bid or <input type="checkbox"/> Alt.# ___ Tree Removal			
REF. NO.	QUANTITY:	UNIT OF MEASURE:	UNIT PRICE	UNIT PRICE EXTENSION ( <i>Quantity times Unit Price</i> )
70	5	EA		

DESCRIPTION:	<input checked="" type="checkbox"/> Base Bid or <input type="checkbox"/> Alt.# ___ Tree Replacement			
REF. NO.	QUANTITY:	UNIT OF MEASURE:	UNIT PRICE	UNIT PRICE EXTENSION ( <i>Quantity times Unit Price</i> )
71	15	EA		

DESCRIPTION:	<input checked="" type="checkbox"/> Base Bid or <input type="checkbox"/> Alt.# ___ Doghouse Manhole			
--------------	---	--	--	--

REF. NO.	QUANTITY:	UNIT OF MEASURE:	UNIT PRICE	UNIT PRICE EXTENSION ( <i>Quantity times Unit Price</i> )
72	7	EA		

DESCRIPTION:	<input checked="" type="checkbox"/> Base Bid or <input type="checkbox"/> Alt.# ___ Plug and Abandon 8" Sewer Main			
REF. NO.	QUANTITY:	UNIT OF MEASURE:	UNIT PRICE	UNIT PRICE EXTENSION ( <i>Quantity times Unit Price</i> )
73	300	LF		

DESCRIPTION:	<input checked="" type="checkbox"/> Base Bid or <input type="checkbox"/> Alt.# ___ Abandon Sewer Manhole			
REF. NO.	QUANTITY:	UNIT OF MEASURE:	UNIT PRICE	UNIT PRICE EXTENSION ( <i>Quantity times Unit Price</i> )
74	1	EA		

DESCRIPTION:	<input checked="" type="checkbox"/> Base Bid or <input type="checkbox"/> Alt.# ___ Sanitary Sewer Flow Diversion, Beyond 48 Hours			
REF. NO.	QUANTITY:	UNIT OF MEASURE:	UNIT PRICE	UNIT PRICE EXTENSION ( <i>Quantity times Unit Price</i> )
75	3,040	HR		

DESCRIPTION:	<input checked="" type="checkbox"/> Base Bid or <input type="checkbox"/> Alt.# ___ Sanitary Sewer Flow Diversion, Setup & 48- Hour Operation			
REF. NO.	QUANTITY:	UNIT OF MEASURE:	UNIT PRICE	UNIT PRICE EXTENSION ( <i>Quantity times Unit Price</i> )
76	14	EA		

DESCRIPTION:	<input checked="" type="checkbox"/> Base Bid or <input type="checkbox"/> Alt.# ___ Repair Water Main with Full Circle Clamp (Pipe Size 4" – 8")			
REF. NO.	QUANTITY:	UNIT OF MEASURE:	UNIT PRICE	UNIT PRICE EXTENSION ( <i>Quantity times Unit Price</i> )
77	5	EA		

DESCRIPTION:	<input checked="" type="checkbox"/> Base Bid or <input type="checkbox"/> Alt.# ___ Repair Water Main with Full Circle Clamp (Pipe Size 12" – 16")			
REF. NO.	QUANTITY:	UNIT OF MEASURE:	UNIT PRICE	UNIT PRICE EXTENSION ( <i>Quantity times Unit Price</i> )
78	5	EA		

DESCRIPTION:	<input checked="" type="checkbox"/> Base Bid or <input type="checkbox"/> Alt.# ___ Repair Water Main with Bell Joint Clamp (Pipe Size 4" – 12")			
REF. NO.	QUANTITY:	UNIT OF MEASURE:	UNIT PRICE	UNIT PRICE EXTENSION ( <i>Quantity times Unit Price</i> )
79	5	EA		

DESCRIPTION:	<input checked="" type="checkbox"/> Base Bid or <input type="checkbox"/> Alt.# ___ Repair Water Main with Bell Joint Clamp (Pipe Size 16" – 24")			
REF. NO.	QUANTITY:	UNIT OF MEASURE:	UNIT PRICE	UNIT PRICE EXTENSION ( <i>Quantity times Unit Price</i> )
80	5	EA		

DESCRIPTION:	<input checked="" type="checkbox"/> Base Bid or <input type="checkbox"/> Alt.# ___ Replace 5/8" To 1" Lead Water House Connection With 1" Water House Connection (From Main To Meter)			
REF. NO.	QUANTITY:	UNIT OF MEASURE:	UNIT PRICE	UNIT PRICE EXTENSION ( <i>Quantity times Unit Price</i> )
81	25	EA		

DESCRIPTION:	<input checked="" type="checkbox"/> Base Bid or <input type="checkbox"/> Alt.# ___ Replace 1-1/2" Lead Water House Connection (From Main to Meter)			
REF. NO.	QUANTITY:	UNIT OF MEASURE:	UNIT PRICE	UNIT PRICE EXTENSION ( <i>Quantity times Unit Price</i> )
82	5	EA		

DESCRIPTION:	<input type="checkbox"/> Base Bid or <input type="checkbox"/> Alt.# ___ Replace Existing 2" Lead Water House Connection (From Main to Meter)			
REF. NO.	QUANTITY:	UNIT OF MEASURE:	UNIT PRICE	UNIT PRICE EXTENSION ( <i>Quantity times Unit Price</i> )
83	5	EA		

**Wording for "DESCRIPTION" is provided by the Owner.**

**All quantities are estimated. The contractor will be paid based upon actual quantities as verified by the Owner**

1-2 ADDITIONAL REQUIREMENTS

All blank spaces in this Proposal section shall be filled. A bid price shall be indicated for each bid item. Bids received without all such items completed will be considered non-responsive. The bid shall contain an acknowledgement of receipt of all Addenda in space provided. The Louisiana Uniform Public Work Bid Form & Unit Price Form (if applicable) and the amount of Deposit or Bid Bond five percent (5%) of the total amount of the proposal is REQUIRED to be submitted in a sealed envelope on bid opening date. The two (2) lowest numerical bidders have three (3) days after the bid opening (exclusive of Saturdays, Sundays and Holidays) to submit any additional information such as (Voluntary Extension Sheet, Affidavit, Economically Disadvantage Business Summary Sheet if applicable) as well as requirements of Sections 1-3 through 1-6 below. Failure to do so will render the bid non-responsive.

1-3 BIDDER DECLARATION

\_\_\_\_\_ do hereby declare that \_\_\_\_\_ the only person \_\_\_\_\_ interested in this proposal and that no other person than the one \_\_\_\_\_ herein named have any interest herein or in the contract proposed to be taken; that it is made without any connection with any other person or persons making proposal for the same work and that it is in all respects fair and without collusion or fraud; also that no member of the Sewerage and Water Board or of the City Council of the City of New Orleans or any officer or employee of the City of New Orleans or of the several boards thereof, who are by law excluded from participation herein, and directly or indirectly interested herein or in furnishing bond or in any portion of the profits hereof.

\_\_\_\_\_ do hereby also declare that \_\_\_\_\_ have LOUISIANA CONTRACTOR'S LICENSE in the field of \_\_\_\_\_ with NUMBER \_\_\_\_\_.

And \_\_\_\_\_ do further declare that \_\_\_\_\_ have carefully examined the annexed specifications and the drawings furnished, and personally inspected the ground and that \_\_\_\_\_ will contract to provide the necessary tools, machinery and apparatus and other means of construction, and to furnish all labor and material specified in this contract or called for by the plans, necessary to complete the work in the manner specified and within the time mentioned in the specifications and according to the requirements of the Engineer, as herein set forth.

1-4 In accordance with Louisiana Revised Statute 38:2227 the following affidavit shown on the next page must be submitted with the bid, or no later than 3 days after the bid opening (excluding Saturdays, Sundays, and Holidays). Failure to do so will render the bid non-responsive. **Please note, THE AFFIDAVIT MUST BE NOTARIZED.**

1-5 GUARANTEES

\_\_\_\_\_ guarantee that the whole of the work under this contract will be substantially completed within 300 calendar days after the date of the "Commencement of Contract Times."

In case of delay in the completion of the contract beyond the contract time of completion as determined by the Board hereby agree to pay, as liquidated damages, the sum of **Two Thousand Dollars (\$2,000.00)** for each calendar day of such delay, which liquidated damages shall become due by the mere elapsing of the delay without the necessity of putting \_\_\_\_\_ in default.

1-6 EMERGENCY PROCEDURES

Contractor must furnish telephone numbers for routine or emergency telephone calls.

NAME \_\_\_\_\_ TITLE \_\_\_\_\_

TELEPHONE NO.:  
NORMAL CALLS \_\_\_\_\_

EMERGENCY \_\_\_\_\_

1-7 ACKNOWLEDGEMENT OF CONSENT DECREE

I, \_\_\_\_\_, hereby certify that I have read and understand the Consent Decree with attachments or the pertinent parts thereof and am familiar with the terms and conditions therein and will pay any fines or penalties that will be assessed against the Sewerage and Water Board or City of New Orleans (or reimburse them therefor) which are imposed by the terms of said Decree with attachments resulting from the action or actions of \_\_\_\_\_ in its performance of or its failure to perform its duties under this Contract.

STATE OF LOUISIANA  
PARISH OF ORLEANS

**AFFIDAVIT**

BEFORE ME, the undersigned authority, duly commissioned and qualified and sworn in and for the State and Parish aforesaid, personally came and appeared \_\_\_\_\_ who after being duly sworn, did depose and say as follows:

- 1) He/she is the \_\_\_\_\_ (title) of \_\_\_\_\_ (company);
- 2) He/she has not been convicted of, or has entered a plea of guilty or nolo contendere to any of the crimes, or equivalent federal crimes, listed in Louisiana Revised Statute 38:2227, specifically: public bribery, corrupt influencing, extortion, money laundering, theft, identity theft, theft of a business record, false accounting, issuing worthless checks, bank fraud, forgery, contractors misapplication of payments, malfeasance in office.
- 3) The contracting entity, person or corporation whose principal(s), member(s), and /or Officer(s) have, within the preceding 5 years, not been convicted or plead guilty to, a felony under state or federal statutes, for embezzlement, theft of public funds, bribery, falsification or destruction of public records; (City Code Section 2-8)
- 4) The following is a list of individual partners, incorporators, directors, managers, officers, organizers, or members who have a minimum ten percent interest ownership interest in the bidding entity:

_____ (name)	_____ (name)
_____ (name)	_____ (name)
_____ (name)	_____ (name)

- 5) No other persons hold an ownership interest in the bidding entity via a counter letter.
- 6) None of the above named individual partners, incorporators, directors, managers, officers, organizers, or members, who has a minimum ten percent interest ownership in the bidding entity, been convicted of, or has entered a plea of guilty or nolo contendere to any of the crimes, or equivalent federal crimes, listed in Louisiana Revised Statute 38:2227, specifically: public bribery, corrupt influencing, extortion, money laundering, theft, identity theft, theft of a business record, false accounting, issuing worthless checks, bank fraud, forgery, contractors misapplication of payments, malfeasance in office.
- 7) He/she is not delinquent on any taxes owed the City of New Orleans or fees/charges to the Sewerage and Water Board. (City Code Section 2-8)

The following sections apply only to Public Works Contracts:

- 8) In accord with LA Revised Statute 38:2212.10 the entity represented herein is registered and participates in the "Status verification system" of the Illegal Immigration Reform and Immigrant Responsibility Act of 1996, 8 U.S.C. 1324(a), known as the "E-Verify" program to verify that all employees in the State of Louisiana are legal citizens of the United States or are legal aliens.
- 9) The entity represented herein shall continue, during the term of the contract, to utilize a status verification system to verify the legal status of all new employees in the state of Louisiana.
- 10) The entity represented herein shall require all subcontractors to submit to the contractor a sworn affidavit verifying compliance with the Status verification system.

**WITNESSES:**

\_\_\_\_\_  
\_\_\_\_\_

\_\_\_\_\_  
**AFFIANT**

**SWORN TO AND SUBSCRIBED BEFORE ME ON THIS**

\_\_\_\_\_ DAY OF \_\_\_\_\_, 20\_\_\_\_.

\_\_\_\_\_  
**NOTARY PUBLIC**

\_\_\_\_\_  
**Notary Id. No. or Bar Roll No.**

\_\_\_\_\_  
**PLEASE PRINT NAME OF NOTAR**

## SECTION 01 22 00 - UNIT PRICES

### PART 1 - GENERAL

#### 1.1 RELATED DOCUMENTS

- A. Drawings and general provisions of the Contract, including General and Supplementary Conditions and other Division 01 Specification Sections, apply to this Section.

#### 1.2 SUMMARY

- A. Section includes administrative and procedural requirements for unit prices.
- B. Related Requirements:
  - 1. Section 012600 "Contract Modification Procedures" for procedures for submitting and handling Change Orders.

#### 1.3 DEFINITIONS

- A. Unit price is a price per unit of measurement for plant, labor, construction aids, utilities, pumping, mobilization, sewer flow control, materials, equipment, supplies or services, or a portion of the Work, added to or deducted from the Contract Sum by appropriate modification, if the scope of Work or estimated quantities of Work required by the Contract Documents are increased or decreased.

#### 1.4 PROCEDURES

- A. Unit prices include all necessary material, plus cost for delivery, installation, insurance, overhead, profit, and all other incidentals.
- B. Measurement and Payment: See individual Specification Sections for work that requires establishment of unit prices. Methods of measurement and payment for unit prices are specified in those Sections.
- C. Owner reserves the right to reject Contractor's measurement of work-in-place that involves use of established unit prices and to have this work measured, at Owner's expense, by an independent surveyor.
- D. List of Unit Prices: A schedule of unit prices is included in Part 3 Execution. Specification Sections referenced in the schedule contain requirements for materials described under each unit price.
- E. For measuring progress toward Consent Decree Milestones, the percent complete will be calculated by dividing the value of work that has been completed and approved by the Engineer by the total bid amount for the milestone items, for **pay items 27 through 67 and 70**.

## PART 2 - PRODUCTS (NOT USED)

## PART 3 - EXECUTION

### 3.1 SCHEDULE OF UNIT PRICES

- A. Unit Price No. 1: Removal and Disposal of Existing Portland Cement Concrete Pavement
  - 1. Description: This work consists of removal and satisfactory disposal of existing PCCP Roadway.
  - 2. Unit of Measurement: Square Yard
- B. Unit Price No. 2: Removal and Disposal of Existing Sidewalk, Driveway, Foot Lap (Concrete, Brick, Asphalt, Etc.)
  - 1. Description: This work consists of removal and satisfactory disposal of existing sidewalk, driveway, foot lap (concrete, brick asphalt, or other materials, or combinations of materials).
  - 2. Unit of Measurement: Square Yard
- C. Unit Price No. 3: Removal and Disposal of Existing Curb (Concrete, Asphalt, Brick, or Etc.)
  - 1. Description: This work consists of removal and satisfactory disposal of existing curb (concrete, asphalt, brick, or other materials, or combinations of materials).
  - 2. Unit of Measurement: Linear Foot
- D. Unit Price No. 4: Removal and Disposal of Existing Curb and Gutter Bottom
  - 1. Description: This work consists of removal and satisfactory disposal of existing curb and gutter bottom (concrete, asphalt, brick, or other materials, or combinations of materials).
  - 2. Unit of Measurement: Linear Foot
- E. Unit Price No. 5: Removal and Disposal of Existing Asphaltic Concrete Pavement.
  - 1. Description: This work consists of removal and satisfactory disposal of existing asphaltic concrete pavement.
  - 2. Unit of Measurement: Square Yard
- F. Unit Price No. 12: Roadway Excavation
  - 1. Description: This work consists of excavation of roadway base and earthen material beneath roadway pavement to be replaced as required to establish pre-existing or field modified grades, excluding any excavation inclusive to excavated sewer or water repairs in accordance with Division 31 and Division 32 of the specifications.
  - 2. Unit of Measurement: Cubic Yard

- G. Unit Price No. 7: Unsuitable Subgrade Excavation and Sand Filling
1. Description: This work consists of removal of existing subgrade and filling the roadway back with sand.
  2. Unit of Measurement: Cubic Yard
- H. Unit Price No. 8: Geotextile Fabric for Stabilization
1. Description: This work consists of furnishing and installing all geotextile fabrics for embankment separation, subgrade reinforcement of roadways, subsurface drainage, or riprap lining in a manner and at locations as detailed and specified according to Section 310519 "Geosynthetics for Earthwork", as shown in the drawings or as otherwise directed by the Construction Manager.
  2. Unit of Measurement: Square Yard
- I. Unit Price No. 9: Geogrid
1. Description: This work consists of furnishing and installing all geogrid for embankment separation, subgrade reinforcement of roadways, subsurface drainage, or riprap lining in a manner specified according to Section 310519 "Geosynthetics for Earthwork", in locations shown in the drawings or as otherwise directed by the Construction Manager.
  2. Unit of Measurement: Square Yard
- J. Unit Price No. 10: Base Course
1. Description: This work includes procuring and properly installing aggregate base course on acceptable subbase, as indicated on the drawings and specified herein according to Section 321123 "Aggregate Base Course". The work also includes all efforts necessary to schedule and allow for testing of material, as well as satisfactory removal and cleanup of unused material from the work site.
  2. Unit of Measurement: Cubic Yard
- K. Unit Price No. 11: Superpave Asphaltic Concrete for Leveling
1. Description: Superpave asphaltic concrete leveling course consists of the supplying, placing and compaction of plant mix asphalt concrete over ruts, distortion, depressions, and other irregularities to rework and restore proper grade and cross section to the existing pavement according to Section 321216 "Asphalt Paving."
- L. Unit Price No. 12: Superpave Asphaltic Concrete Wearing Course (2.5" Thick)
1. Description: This work consists of placing an asphaltic concrete wearing surface course (2.5" Thick), to the specified thickness, on binder course in conformity with the typical sections shown in the New Orleans DPW Standard Details and according to Section 321216 "Asphalt Paving."
  2. Unit of Measurement: Square Yard



- M. Unit Price No. 13: Superpave Asphaltic Concrete Binder Course (4.5" Thick)
1. Description: This work consists of placing concrete binder course (4.5" Thick), to the specified thickness, on precast concrete in conformity with the typical sections shown in the New Orleans DPW Standard Details and according to Section 321216 "Asphalt Paving."
  2. Unit of Measurement: Square Yard
- N. Unit Price No. 14: Cold Planning Asphaltic Pavement (2" Average Thick)
1. Description: This work consists of placing cold asphalt (2" Average Thick), to the specified thickness, on milled asphalt in conformity with the typical sections shown in the New Orleans DPW Standard Details and according to Section 321216 "Asphalt Paving."
  2. Unit of Measurement: Square Yard
- O. Unit Price No. 15: Reinforced Concrete Pavement (8" Thick)
1. Description: This work consists of constructing roadway pavement in conformance with the specifications and in conformity with the locations, lines, grades, slopes, thickness, sections, and strength shown in the New Orleans DPW Standard Details and according to Section 321313 "Concrete Paving."
  2. Unit of Measurement: Square Yard
- P. Unit Price No. 16: Concrete Sidewalk (4" Thick)
1. Description: This work consists of constructing concrete sidewalks in conformance with the specifications and in conformity with the locations, lines, grades, slopes, thickness, sections, and strength shown in the New Orleans DPW Standard Details and according to Section 321623 "Sidewalks and Driveways."
  2. Unit of Measurement: Square Yard
- Q. Unit Price No. 17: Concrete Driveway (6" Thick)
1. Description: This work consists of constructing concrete driveways in conformance with the specifications and in conformity with the locations, lines, grades, slopes, thickness, sections, and strength shown on the plans and according to Section 321623 "Sidewalks and Driveways."
  2. Unit of Measurement: Square Yard
- R. Unit Price No. 18: 6" Concrete Barrier Curb with Dowels
1. Description: This work consists of furnishing and construction of 6" concrete barrier curb with dowels in accordance with the specifications and in conformity with the location, lines, grades, slopes, thickness, and typical section shown in the New Orleans DPW Standard Details and according to Section 321613 "Curbs and Gutters."
  2. Unit of Measurement: Linear Foot

- S. Unit Price No. 19: Concrete Mountable Curb and Gutter Bottom or Rolling Strip
1. Description: This work consists of furnishing and construction of concrete mountable curb and gutter bottom or rolling strip in accordance with the specifications and in conformity with the location, lines, grades, slopes, thickness, and typical section shown in the New Orleans DPW Standard Details and according to Section 321613 "Curbs and Gutters."
  2. Unit of Measurement: Linear Foot
- T. Unit Price No. 20: 6" Concrete Barrier Curb & Gutter Bottom or Rolling Strip
1. Description: This work consists of furnishing and construction of 6" concrete barrier curb and gutter bottom or rolling strip in accordance with the specifications and in conformity with the location, lines, grades, slopes, thickness, and typical section shown in the New Orleans DPW Standard Details and according to Section 321613 "Curbs and Gutters."
  2. Unit of Measurement: Linear Foot
- U. Unit Price No. 21: Sodding
1. Description: This work consists of furnishing, hauling, planting, rolling, watering, and maintaining placed and in-place live grass sod at locations shown on the plans or as directed according to Section 329223 "Sodding."
  2. Unit of Measurement: Square Yard
- V. Unit Price No. 22: Saw Cut Concrete Curb, Pavement, Sidewalk, Driveway, Etc. According to Plans ("Depth)
1. Description: Existing asphaltic concrete, PCC, or composite pavement, including roadway, sidewalk, driveway, curb, gutter and similar materials to be removed, shall be saw cut, to the full depth of the pavement, in straight lines to the nearest construction joint unless otherwise directed by the Construction Manager.
  2. Unit of Measurement: Linear Foot
- W. Unit Price No. 23: Saw Cut, Wheel Cut, or Spade Cut Existing Asphalt According to Plans
1. Description: Existing asphaltic concrete pavement, including roadway, sidewalk, driveway, curb, gutter and similar materials to be removed, shall be saw cut, to the full depth of the pavement, in straight lines to the nearest construction joint unless otherwise directed by the Construction Manager.
  2. Unit of Measurement: Linear Foot
- X. Unit Price No. 24: Removal of Handicap ramps, Curb and Gutter, and Concrete Sidewalks at Intersections Including Saw Cutting.
1. Description: This work consists of removal and satisfactory disposal of existing handicap ramps, curb and gutter, and concrete sidewalks at intersections including saw cutting.
  2. Unit of Measurement: Square Yard

- Y. Unit Price No. 25: Handicap Ramps, Curbs and Gutter, and Concrete Sidewalks at Intersections
1. Description: This work consists of all excavation, surface preparation, joint materials, welded wire fabrics, ADA compliant detectable warnings, and incidentals associated with the installation of ADA accessible handicap ramps.
  2. Unit of Measurement: Square Yard
- Z. Unit Price No. 26: Sidewalk Transition Adjacent to Handicapped Ramps
1. Description: This work consists of all excavation, surface preparation, joint materials, welded wire fabrics, and incidentals associated with the installation of ADA accessible handicap ramps and their adjacent sidewalk transitions.
  2. Unit of Measurement: Square Yard
- AA. Unit Price No. 27: Manhole Cover
1. Description: This work consists of the replacing an existing manhole cover with a new manhole cover, Section 330130.83 “Rehabilitation of Manholes.”
  2. Unit of Measurement: Each
- BB. Unit Price No. 28: Manhole Frame
1. Description: This work consists of the replacing an existing manhole frame with a new manhole frame, Section 330130.83 “Rehabilitation of Manholes.”
  2. Unit of Measurement: Each
- CC. Unit Price Nos. 29 - 32: Install Sewer Main
1. Description: This work consists of the installation of sewer pipelines and sewer service laterals by means of excavation including full line replacement, partial line replacement (point repair) and line relocations according to Sections 330130.73 “Rehabilitation of Sewers” and 333111 “Public Sewerage Gravity Piping.”
  2. Unit of Measure: Linear Foot
  3. This unit price is broken down into specific pay items based on nominal pipe diameter and average depth of sewer pipe invert as per the Bid Form.
  4. Unit Prices by Diameter: Measurement and Payment for these Unit Price items will be made by the nominal diameter as per the Bid Form.
  5. Unit Prices by Pipe Invert Depth: Measurement and payment for these unit price items will be made by the average depth of sewer pipe invert as per the Bid Form.
    - a. Unit Price No. 29: Six-Inch (6”) Diameter at 0-ft to 6.0-ft Depth
    - b. Unit Price No. 30: Eight-Inch (8”) Diameter at 0-ft to 6.0-ft Depth
    - c. Unit Price No. 31: Eight-Inch (8”) Diameter at 6.1-ft to 8.0-ft Depth
    - d. Unit Price No. 32: Eight-Inch (8”) Diameter at 8.1-ft to 10.0-ft Depth
    - e. Unit Price No. 33: Thirty-Six-Inch (36”) Diameter at 14.1-ft to 16.0-ft Depth

DD. Unit Price No. 34: Pipe Bursting, 27” HDPE

1. Description: The work consists of replacing an existing sewer line with a new high-density polyethylene (HDPE) sewer line by means of pipe bursting and includes the excavation and restoration of sewer service laterals according to Sections 330130.79 “Pipe Bursting.”
2. Unit of Measure: Linear Foot
3. This unit price is broken down into specific pay items based on nominal pipe diameter as per the Bid Form.
4. Unit Prices by Diameter: Measurement and Payment for these Unit Price items will be made by the nominal diameter as per the Bid Form.
  - a. Unit Price No. 34: Twenty-Seven-Inch (27”) Main Diameter.

EE. Unit Price No. 35: Replace Existing, Sewer House Connection (H.C.) From New Main to Back of Curb

1. Description: This work consists of the replacement of sewer house connected pipelines and sewer service laterals by means of excavation including full line replacement, partial line replacement (point repair) and line relocations from the sewer main to the back of curb according to Section 330130.73 “Rehabilitation of Sewers.”
2. Unit of Measure: Each

FF. Unit Price No. 36: Replace Existing Sewer H.C. Beyond Back of Curb

1. Description: This work consists of the replacement of sewer house connected pipelines and sewer service laterals by means of excavation including full line replacement, partial line replacement (point repair) and line relocations from the back of curb to the property line according to Section 330130.73 “Rehabilitation of Sewers.”
2. Unit of Measure: Linear Foot

GG. Unit Price No. 37: Install 6” Sewer Cleanout

1. Description: The work consists of installing a new sewer cleanout in accordance with section 330509 “Piping Specialties For Sewer Utilities”
2. Unit of Measure: Each

HH. Unit Price No. 38: Install Sewer Manhole

1. Description: The work consists of installing a new sewer manhole in accordance with section 330130.83 “Rehabilitation of Manholes.”
2. Unit of Measure: Vertical Feet

II. Unit Price Nos. 39 – 46: Pipe Liner, CIPP

1. Description: This work consists of providing cured-in-place pipe (CIPP) liners for rehabilitation of sewer pipelines according to section 030130.76 “Cured-In-Place Pipe Lining.”
2. Unit of Measure: Linear Foot
3. This unit price is broken down into specific pay items based on nominal pipe diameter as per the sub-sections specified below.

4. Schedule of Unit Prices by Diameter: Measurement and Payment for these Unit Price items will be made by the nominal diameter for the following Unit Price numbers:
  - a. Unit Price No. 39: Eight-Inch (8") Diameter Pipes
  - b. Unit Price No. 40: Ten-Inch (10") Diameter Pipes
  - c. Unit Price No. 41: Twelve-Inch (12") Diameter Pipes
  - d. Unit Price No. 42: Fifteen -Inch (15") Diameter Pipes
  - e. Unit Price No. 43: Eighteen-Inch (18") Diameter Pipes
  - f. Unit Price No. 44: Twenty-One-Inch (21") Diameter Pipes
  - g. Unit Price No. 45: Twenty-Seven-Inch (27") Diameter Pipes
  - h. Unit Price No. 46: Thirty-Six-Inch (36") Diameter Pipes

JJ. Unit Price No. 47: Cut Liner to Restore Existing Sewer House Connection (6", CIPP)

1. Description: This work consists of cutting pipe liner to restore existing house connection according to section 030130.76 "Cured-In-Place Pipe Lining."
2. Unit of Measure: Each

KK. Unit Price Nos. 48-55: Sewer Point Repair, Up to 12 Feet

1. Description: This work consists of the rehabilitation of sewer pipelines and sewer service laterals by means of excavation including full line replacement, partial line replacement (point repair) and line relocations according to Section 330130.73 "Rehabilitation of Sewers."
2. Unit of Measure: Each
3. This unit price is broken down into specific pay items based on nominal pipe diameter and average depth of inverts as per the specific unit price items as stated on the Bid Form.
4. Unit Prices by Diameter: Measurement and payment for these unit price items will be made by the nominal diameter as per the Bid Form.
5. Unit Prices by Invert Depth: Measurement and payment for these unit price items will be made by the average depth of invert per the Bid Form.
  - a. Unit Price No. 48: Eight-Inch (8") Diameter at 8.1-ft to 10.0-ft Depth
  - b. Unit Price No. 49: Ten-Inch (10") Diameter at 10.1-ft to 12.0-ft Depth
  - c. Unit Price No. 50: Twelve-Inch (12") Diameter at 10.1-ft to 12.0-ft Depth
  - d. Unit Price No. 51: Eighteen-Inch (18") Diameter at 14.1-ft to 16.0-ft Depth
  - e. Unit Price No. 52: Twenty-One-Inch (21") Diameter at 14.1-ft to 16.0-ft Depth
  - f. Unit Price No. 53: Twenty-Seven-Inch (27") Diameter at 10.1-ft to 12.0-ft Depth
  - g. Unit Price No. 54: Twenty-Seven-Inch (27") Diameter at 12.1-ft to 14.0-ft Depth
  - h. Unit Price No. 55: Thirty-Six-Inch (36") Diameter at 14.1-ft to 16.0-ft Depth

LL. Unit Price Nos. 56-62: Sewer Point Repair, Beyond 12 Feet

1. Description: This work consists of the rehabilitation of sewer pipelines and sewer service laterals by means of excavation including full line replacement, partial line replacement (point repair) and line relocations beyond 12 feet according to Section 330130.73 "Rehabilitation of Sewers."
2. Unit of Measure: Linear Foot
3. This unit price is broken down into specific pay items based on nominal pipe diameter and average depth of inverts as per the Bid Form.
4. Unit Prices by Diameter: Measurement and payment for these unit price items will be made by the nominal diameter as per the Bid Form.

5. Unit Prices by Average Invert Depth: Measurement and payment for these unit Price items will be made by the average depth of inverts per the Bid Form.
  - a. Unit Price No. 56: Ten-Inch (10") Diameter at 10.1-ft to 12.0-ft Depth
  - b. Unit Price No. 57: Twelve-Inch (12") Diameter at 10.1-ft to 12.0-ft Depth
  - c. Unit Price No. 58: Eighteen-Inch (18") Diameter at 14.1-ft to 16.0-ft Depth
  - d. Unit Price No. 59: Twenty-One-Inch (21") Diameter at 14.1-ft to 16.0-ft Depth
  - e. Unit Price No. 60: Twenty-Seven-Inch (27") Diameter at 10.1-ft to 12.0-ft Depth
  - f. Unit Price No. 61: Twenty-Seven-Inch (27") Diameter at 12.1-ft to 14.0-ft Depth
  - g. Unit Price No. 62: Thirty-Six-Inch (36") Diameter at 14.1-ft to 16.0-ft Depth

MM. Unit Price No. 63-66: Sewer Main Cleaning

1. Description: This work consists of cleaning sewer pipelines, sewer service laterals and manholes to remove all debris, solids, grit, sand, gravel, shells, grease, etc. as per the requirements set forth in these specifications and related requirements according to Section 330130 "Operation and Maintenance of Sewer Utilities."
2. Unit of Measurement: Linear Foot
3. This unit price is broken down into specific pay items based on nominal pipe diameter as per the sub-sections specified below.
4. Schedule of Unit Prices by Diameter: Measurement and Payment for these Unit Price items will be made by the nominal diameter for the following Unit Price numbers:
  - a. Unit Price No. 63: Eight-Inch (8")- Fourteen-Inch (14") Diameter Pipes
  - b. Unit Price No. 64: Fifteen-Inch (15")- Twenty-One-Inch (21") Diameter Pipes
  - c. Unit Price No. 65: Twenty-Four-Inch (24")- Twenty-Seven-Inch (27") Diameter Pipes
  - d. Unit Price No. 66: Thirty-Three-Inch (33")- Thirty-Six-Inch (36") Diameter Pipes

NN. Unit Price No. 67: Sewer Main Line CCTV Inspection

1. Description: This work consists of performing CCTV inspection of designated sanitary sewer service laterals in accordance with Section 330130.16 "CCTV Inspections of Sewers".
2. Unit of Measurement: Linear Foot

OO. Unit Price Nos. 68: Sewer Service Lateral Lining (6" CIPP)

1. Description: This work consists of providing cured-in-place pipe (CIPP) liners for rehabilitation of sewer pipelines according to section 030130.76 "Cured-In-Place Pipe Lining."
2. Unit of Measure: Each

PP. Unit Price No. 69: Sanitary Sewer Service Lateral CCTV Inspection

1. Description: This work consists of performing CCTV inspection of designated sanitary sewer service laterals in accordance with Section 330130.16 "CCTV Inspections of Sewers".
2. Unit of Measurement: Each

QQ. Unit Price No. 70: Tree Removal

1. Description: This work consists of removing trees as required for construction.

2. Unit of Measure: Each

RR. Unit Price No. 71: Tree Replacement

1. Description: This work consists of replacing removed trees as required by Parks & Parkways specifications.
2. Unit of Measure: Each

SS. Unit Price No. 72: Install Doghouse Manhole

1. Description: The work consists of installing a new doghouse sewer manhole and connect to existing sewer main in accordance with section 330130.83 "Rehabilitation of Manholes."
2. Unit of Measure: Vertical Feet

TT. Unit Price No. 73: Abandon 8" Sewer Main

1. Description: The work consists of abandoning an 8" sewer main in accordance with section 330500 "Common Work Results For Utilities"
2. Unit of Measure: Linear Foot

UU. Unit Price No. 74: Abandon Sewer Manhole

1. Description: The work consists of abandoning a sewer manhole.
2. Unit of Measure: Each

VV. Unit Price No. 75: Sanitary Sewer Flow Diversion, Beyond 48 Hours

1. Description: The work consists bypassing existing sewer discharge during construction after the first 48 hours.
2. Unit of Measure: Hour

WW. Unit Price No. 76: Sanitary Sewer Flow Diversion, Setup & 48- Hour Operation

1. Description: The work consists of setting-up and operating sewer bypass for the first 48 hours.
2. Unit of Measure: Each

XX. Unit Price Nos. 77-78: Repair Water Main with Full Circle Clamp

1. Description: This work consists of the rehabilitation of water mains by means of excavation and installation of full circle clamps including partial line replacement (point repair) and line relocations according to Section 330110.73 Excavated Rehabilitation of Water Utility Piping.
2. Unit of Measure: Each
3. This unit price is broken down into specific pay items based on nominal pipe diameter as per the Bid Form.
4. Unit Prices by Diameter: Measurement and Payment for these Unit Price items will be made by the nominal diameter as per the Bid Form.
  - a. Unit Price No. 77: Pipe Diameter 4" – 8".
  - b. Unit Price No. 78: Pipe Diameter 12"-16"

YY. Unit Price Nos. 79-80: Repair Water Main with Bell Joint Clamp

1. Description: This work consists of the rehabilitation of water mains by means of excavation and installation of bell joint clamps including partial line replacement (point repair) and line relocations according to Section 330110.73 Excavated Rehabilitation of Water Utility Piping.
2. Unit of Measure: Each
3. This unit price is broken down into specific pay items based on nominal pipe diameter as per the Bid Form.
4. Unit Prices by Diameter: Measurement and Payment for these Unit Price items will be made by the nominal diameter as per the Bid Form.
  - a. Unit Price No. 79: Pipe Diameter 4" – 12".
  - b. Unit Price No. 80: Pipe Diameter 16"-24"

ZZ. Unit Price Nos. 81-83: Replace Lead Service Line Water House Connection (From Meter to Main)

1. Description: This work consists of the removal of exposed Lead Service Line Water House Connections with new Polyethylene Water House Connections, from the Water Main to the Water Meter, in accordance with Section 330110.73 Excavated Rehabilitation of Water Utility Piping.
2. Unit of Measure: Each
3. This unit price is broken down into specific pay items based on nominal service line diameter as per the Bid Form.
4. Unit Prices by Diameter: Measurement and Payment for these Unit Price items will be made by the nominal diameter as per the Bid Form.
  - a. Unit Price No. 81: 5/8" to 1" Lead Service Line.
  - b. Unit Price No. 82: 1-1/2" Lead Service Line
  - c. Unit Price No. 83: 2" Lead Service Line

END OF SECTION 012200



**THIS PAGE LEFT INTENTIONALLY BLANK**

Std. Spec.	DESCRIPTION OF ITEM	Unit	Total Qty.
1	REMOVAL AND DISPOSAL OF EXISTING PORTLAND CEMENT CONCRETE PAVEMENT	SY	545
2	REMOVAL AND DISPOSAL OF EXISTING SIDEWALK, DRIVEWAY, FOOT LAP (CONCRETE, BRICK, ASPHALT, ETC.)	SY	1,132
3	REMOVAL AND DISPOSAL OF EXISTING CURB (CONCRETE, ASPHALT, BRICK, ETC.)	LF	75
4	REMOVAL AND DISPOSAL OF EXISTING CURB AND GUTTER BOTTOM	LF	3,825
5	REMOVAL AND DISPOSAL OF EXISTING ASPHALTIC CONCRETE PAVEMENT	SY	4,632
6	ROADWAY EXCAVATION	CY	1,226
7	UNSUITABLE SUBGRADE EXCAVATION AND SAND FILLING	CY	335
8	GEOTEXTILE FABRIC FOR STABILIZATION	SY	10,946
9	GEOGRID	SY	4,903
10	BASE COURSE	CY	1,197
11	SUPERPAVE ASPHALTIC CONCRETE BINDER COURSE FOR COMPOSITE ROADWAYS	TON	87
12	SUPERPAVE ASPHALTIC CONCRETE WEARING COURSE (2.5" THICK)	SY	14,138
13	SUPERPAVE ASPHALTIC CONCRETE BINDER COURSE (4.5" THICK)	SY	4,474
14	COLD PLANING ASPHALTIC PAVEMENT (2" AVERAGE THICK)	SY	13,959
15	REINFORCED CONCRETE PAVEMENT (8" THICK)	SY	300
16	CONCRETE SIDEWALK (4" THICK)	SY	883
17	CONCRETE DRIVEWAY (6" THICK)	SY	249
18	6" CONCRETE BARRIER CURB WITH DOWELS	LF	3,876
19	CONCRETE MOUNTABLE CURB AND GUTTER BOTTOM OR ROLLING STRIP	LF	24
20	6" CONCRETE BARRIER CURB & GUTTERBOTTOM OR ROLLING STRIP	LF	10
21	SODDING	SY	541
22	SAW CUT CONCRETE CURB, PAVEMENT, SIDEWALK, DRIVEWAY, ETC. ACCORDING TO PLANS ("DEPTH)	LF	409
23	SAW CUT, WHEEL CUT OR SPADE CUT EXISTING ASPHALT, ACCORDING TO PLANS	LF	9,117
24	REMOVAL OF HANDICAP RAMPS, CURB AND GUTTER, AND CONCRETE SIDEWALKS AT INTERSECTIONS INCLUDING SAW CUTTING	SY	447
25	HANDICAP RAMPS, CURB AND GUTTER, AND CONCRETE SIDEWALKS AT INTERSECTIONS	SY	447
26	SIDEWALK TRANSITION ADJACENT TO HANDICAPPED RAMPS	SY	429
27	MANHOLE COVER	EA	20
28	MANHOLE FRAME	EA	20
29	INSTALL SEWER MAIN (6" AT 0' - 6.0')	LF	275
30	INSTALL SEWER MAIN (8" AT 0' - 6.0')	LF	2,073
31	INSTALL SEWER MAIN (8" AT 6.1' - 8.0')	LF	450
32	INSTALL SEWER MAIN (8" AT 8.1' - 10.0')	LF	1,026
33	INSTALL SEWER MAIN (36" AT 14.1' - 16.0')	LF	51
34	INSTALL SEWER MAINS BY PIPE BURSTING (27" HDPE, DR11)	LF	466
35	REPLACE EXIST. SEWER H.C. FROM NEW MAIN TO BACK OF CURB	EA	100
36	REPLACE EXIST. SEWER H.C. BEYOND BACK OF CURB	LF	1,135
37	INSTALL 6" SEWER CLEANOUT	EA	2
38	INSTALL SEWER MANHOLE	VF	140
39	PIPE LINER (CIPP, 8")	LF	255
40	PIPE LINER (CIPP, 10")	LF	736
41	PIPE LINER (CIPP, 12")	LF	331
42	PIPE LINER (CIPP, 15")	LF	347

Std. Spec.	DESCRIPTION OF ITEM	Unit	Total Qty.
43	PIPE LINER (CIPP, 18")	LF	351
44	PIPE LINER (CIPP, 21")	LF	360
45	PIPE LINER (CIPP, 27")	LF	1,955
46	PIPE LINER (CIPP, 36")	LF	550
47	CUT LINER TO RESTORE EXISTING SEWER HOUSE CONNECTION (6", CIPP)	EA	65
48	SEWER POINT REPAIR UP TO 12 FEET (8" AT 8.1' - 10.0')	EA	7
49	SEWER POINT REPAIR UP TO 12 FEET (10" AT 10.1' - 12.0')	EA	10
50	SEWER POINT REPAIR UP TO 12 FEET (12" AT 10.1' - 12.0')	EA	7
51	SEWER POINT REPAIR UP TO 12 FEET (18" AT 14.1' - 16.0')	EA	8
52	SEWER POINT REPAIR UP TO 12 FEET (21" AT 14.1' - 16.0')	EA	8
53	SEWER POINT REPAIR UP TO 12 FEET (27" AT 10.1' - 12.0')	EA	7
54	SEWER POINT REPAIR UP TO 12 FEET (27" AT 12.1' - 14.0')	EA	7
55	SEWER POINT REPAIR UP TO 12 FEET (36" AT 14.1' - 16.0')	EA	10
56	SEWER POINT REPAIR BEYOND 12 FEET (10" AT 10.1' - 12.0')	LF	5
57	SEWER POINT REPAIR BEYOND 12 FEET (12" AT 10.1' - 12.0')	LF	5
58	SEWER POINT REPAIR BEYOND 12 FEET (18" AT 14.1' - 16.0')	LF	25
59	SEWER POINT REPAIR BEYOND 12 FEET (21" AT 14.1' - 16.0')	LF	11
60	SEWER POINT REPAIR BEYOND 12 FEET (27" AT 10.1' - 12.0')	LF	31
61	SEWER POINT REPAIR BEYOND 12 FEET (27" AT 12.1' - 14.0')	LF	13
62	SEWER POINT REPAIR BEYOND 12 FEET (36" AT 14.1' - 16.0')	LF	39
63	SEWER MAIN LINE CLEANING (8"-14")	LF	2,829
64	SEWER MAIN LINE CLEANING (15"-21")	LF	698
65	SEWER MAIN LINE CLEANING (24"-27")	LF	1,955
66	SEWER MAIN LINE CLEANING (33"-36")	LF	550
67	SEWER MAIN LINE CCTV INSPECTION	LF	4,563
68	SEWER SERVICE LATERAL LINING (6" CIPP)	EA	65
69	Sanity Sewer Service Lateral CCTV Inspection	EA	65
70	TREE REMOVAL	EA	5
71	TREE REPLACEMENT	EA	15
72	DOGHOUSE MANHOLE	EA	7
73	PLUG AND ABANDON 8" SEWER MAIN	LF	300
74	ABANDON SEWER MANHOLE	EA	1
75	SANITARY SEWER FLOW DIVERSION, BEYOND 48 HOURS	HR	3,040
76	SANITARY SEWER FLOW DIVERSION, SETUP & 48-HOUR OPERATION	EA	14
77	REPAIR WATER MAIN WITH FULL CIRCLE CLAMP (PIPE SIZE 4" - 8")	EA	5
78	REPAIR WATER MAIN WITH FULL CIRCLE CLAMP (PIPE SIZE 12" - 16")	EA	5
79	REPAIR WATER MAIN WITH BELL JOINT CLAMP (PIPE SIZE 4" - 12")	EA	5
80	REPAIR WATER MAIN WITH BELL JOINT CLAMP (PIPE SIZE 16" - 24")	EA	5
81	REPLACE 5/8" TO 1" LEAD WATER HOUSE CONNECTION WITH 1" WATER HOUSE CONNECTION (FROM MAIN TO METER)	EA	25
82	REPLACE 1-1/2" LEAD WATER HOUSE CONNECTION (FROM MAIN TO METER)	EA	5
83	REPLACE EXISTING 2" LEAD WATER HOUSE CONNECTION (FROM MAIN TO METER)	EA	5



1	3/13/2024	QUANTITY CHANGES	DLK
REV.	DATE	DESCRIPTION	BY

**SEWERAGE AND WATER BOARD  
OF NEW ORLEANS**

CARROLLTON BASIN SEWER REHABILITATION NO. 20  
CONTRACT NO. 30261

ESTIMATED BID QUANTITIES

DR.	
TRC.	
CK.	GENERAL SUPERINTENDENT
AP.	
SCALE: AS NOTED	<b>DWG. No. 8991-S</b>
DATE: 2-23-2024	SHEET NO. 3 OF 27

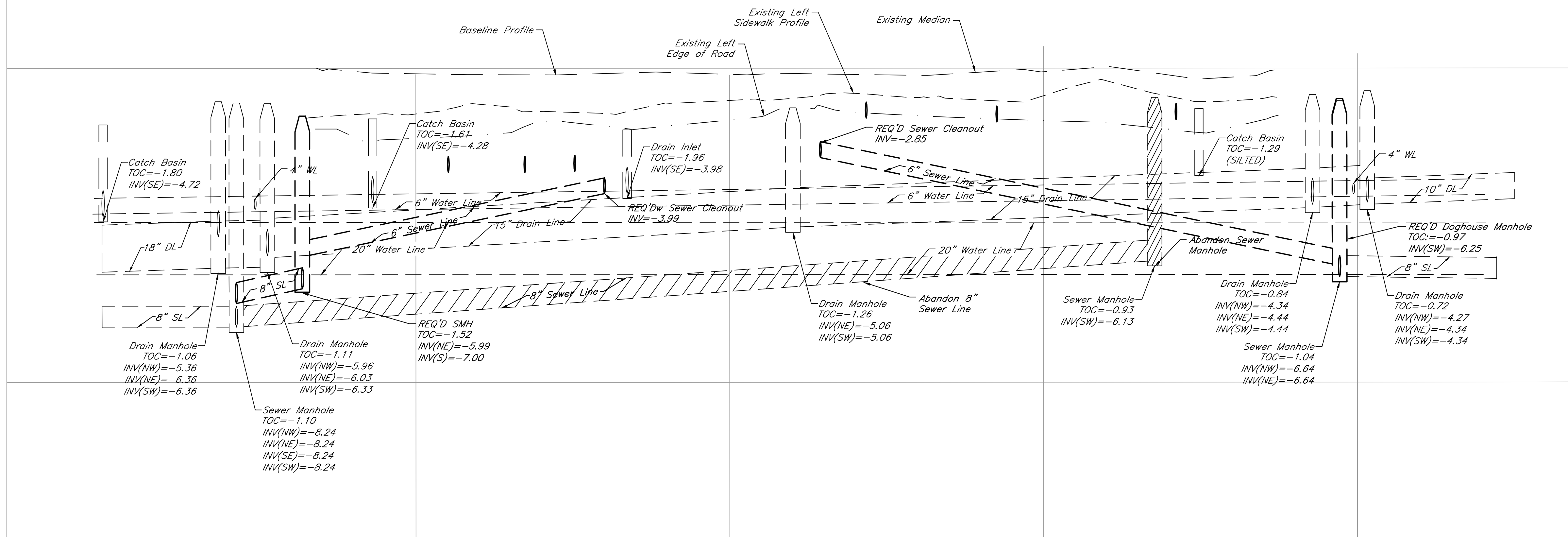
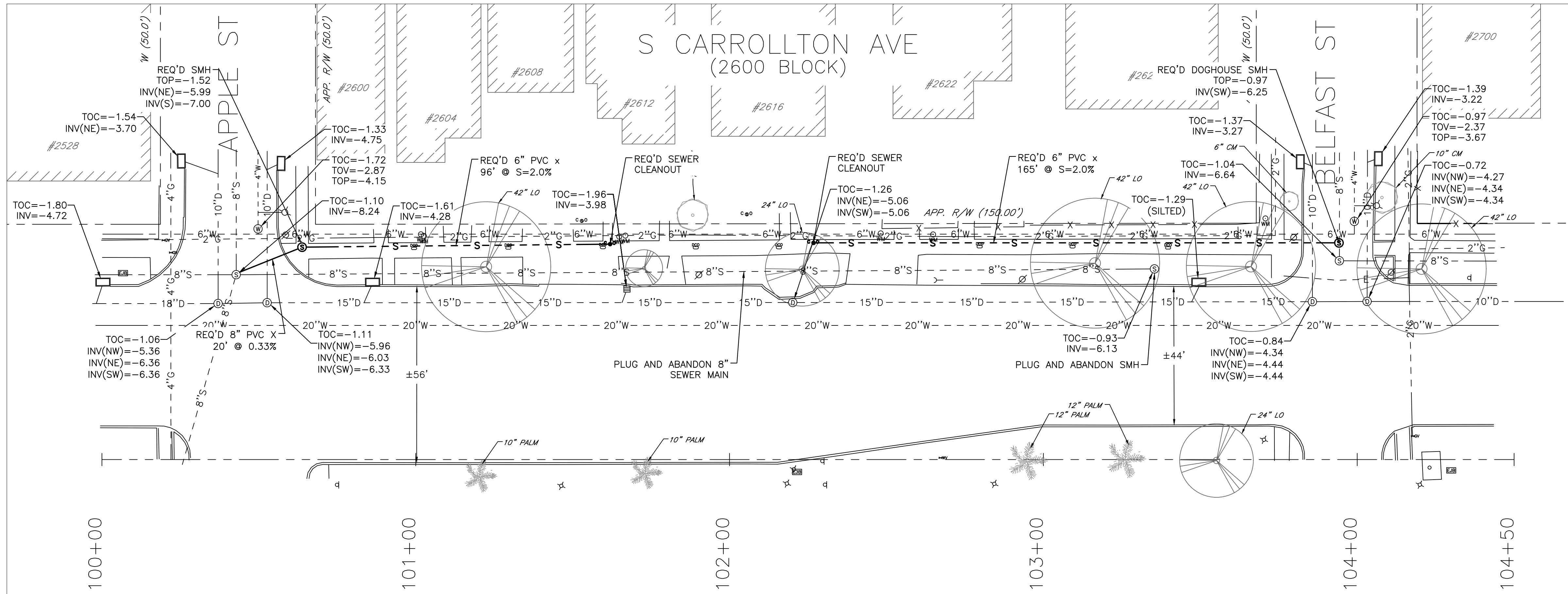

**LEGEND**

	REMOVAL AND REPLACEMENT OF CONCRETE PAVEMENT, SIDEWALK, OR ADA RAMP SWBNO (TRIANG)
	REMOVAL AND REPLACEMENT OF ASPHALT ROADWAY SWBNO (ANSI 131)
	REMOVAL AND REPLACEMENT OF ASPHALT/CONCRETE COMPOSITE ROADWAY SWBNO (ANSI 131/TRIANG)
	COLD MILL/COLD PLANING AND PLACEMENT OF ASPHALT SURFACE COURSE SWBNO (ANSI 133)
	REMOVAL AND REPLACEMENT OF BRICK PAVEMENT, SIDEWALK, OR ADA RAMP SWBNO (BRICK)
	REMOVAL AND REPLACEMENT OF SOD SURFACE COURSE SWBNO (GRASS)
	REMOVAL AND REPLACEMENT OF GRAVEL SURFACE COURSE SWBNO (GRAVEL)
	REMOVAL AND REPLACEMENT OF CURB (ALL TYPES)

NOTE: CONTRACTOR TO FIELD VERIFY THE LOCATION AND DIRECTION OF ALL SERVICE CONNECTIONS.

REV.	DATE	DESCRIPTION	BY
	3/13/24	Addendum 2	R.H.
SEWERAGE AND WATER BOARD OF NEW ORLEANS			
2600 S CARROLLTON			
SEWER REHABILITATION PLANS			
GENERAL SUPERINTENDENT			
DWG. NO. 8991 - S			
SCALE: NTS		SHEET NO. 28	

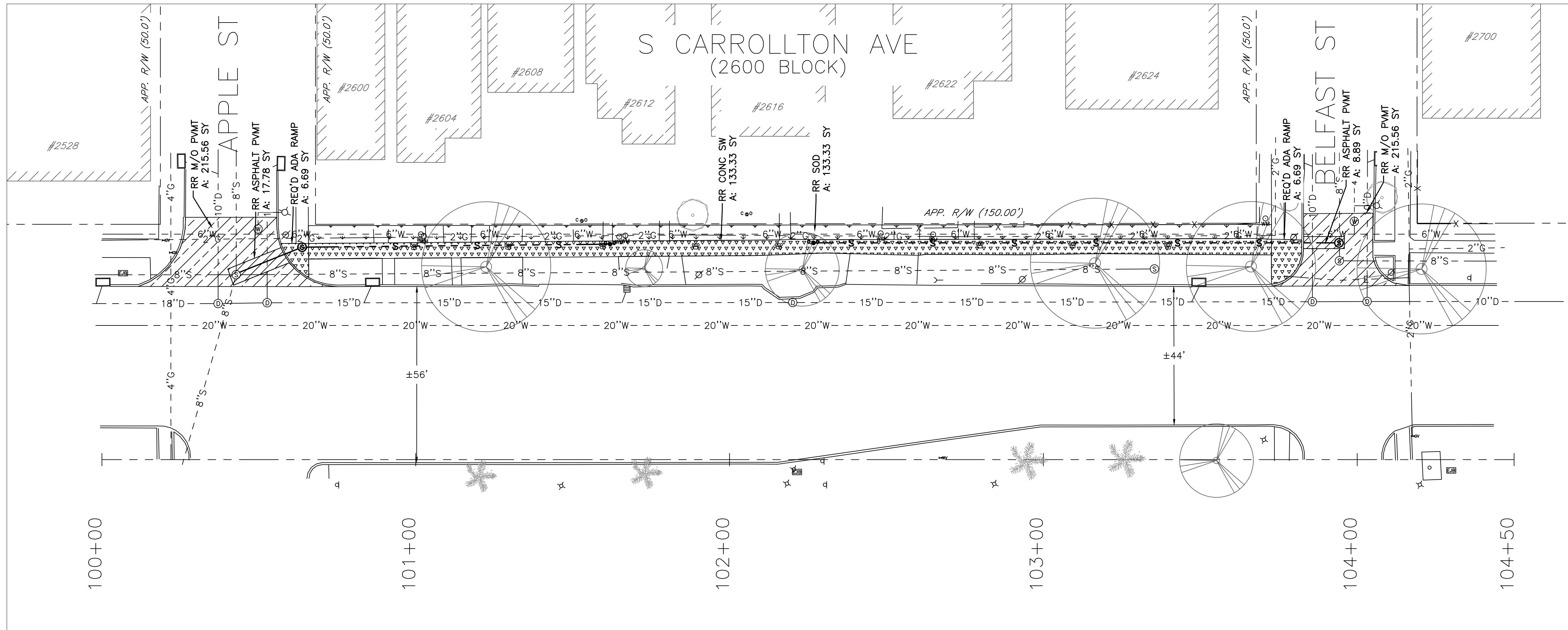

ADDRESS	H.C. NO.	MULTIPLE ADDRESSES	CONNECTION ON	T OR Y FROM O.M.H.	H.C. AT P.L. from O.M.H.	H.C. at P.L. from P.L. of	FROM P.L. OF
2600 S CARROLLTON AV	77375	2602	APPLE	Y 290.20	305	228	CARROLLTON
2601 S CARROLLTON AV	152000		FONTAINBLEAU	Y 358.00	0	0	SHORT
2604 S CARROLLTON AV	77385	2606	CARROLLTON	Y 81.30	84	58	APPLE
2612 S CARROLLTON AV	65434	2614	CARROLLTON	Y 129.50	130	130	BELFAST
2615 S CARROLLTON AV	74743		CARROLLTON	Y 197.00	198	198	FONTAINBLEAU
2618 S CARROLLTON AV	64199		CARROLLTON	Y 152.30	162	135.5	BELFAST
2619 S CARROLLTON AV	64151		CARROLLTON	Y 177.70	179.5	154.5	BELFAST
2624 S CARROLLTON AV	64070		CARROLLTON	Y 256.50	265	238.5	APPLE
2627 S CARROLLTON AV	165780		CARROLLTON	U 116.00		91	BELFAST
2631 S CARROLLTON AV	165779		CARROLLTON	U 101.70		76.7	BELFAST
2639 S CARROLLTON AV	60969		BELFAST	Y 205.70	204	179	CARROLLTON

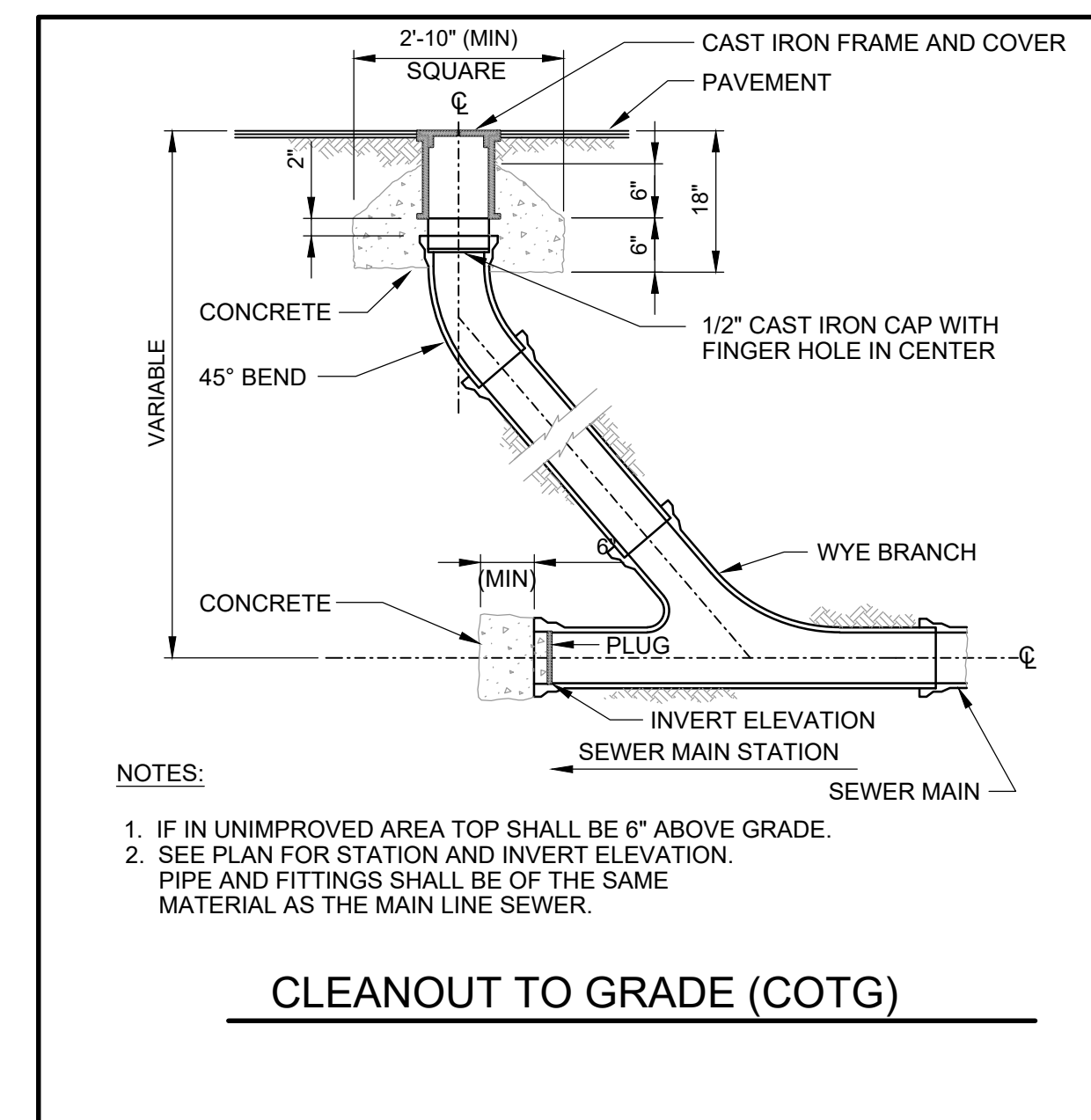

3/19/2024

**LEGEND**

- REMOVAL AND REPLACEMENT OF CONCRETE PAVEMENT, SIDEWALK, OR ADA RAMP SWBNO (TRIANG)
- REMOVAL AND REPLACEMENT OF ASPHALT ROADWAY SWBNO (ANSI 131)
- REMOVAL AND REPLACEMENT OF ASPHALT/CONCRETE COMPOSITE ROADWAY SWBNO (ANSI 131/TRIANG)
- COLD MILL/COLD PLANING AND PLACEMENT OF ASPHALT SURFACE COURSE SWBNO (ANSI 133)
- REMOVAL AND REPLACEMENT OF BRICK PAVEMENT, SIDEWALK, OR ADA RAMP SWBNO (BRICK)
- REMOVAL AND REPLACEMENT OF SOD SURFACE COURSE SWBNO (GRASS)
- REMOVAL AND REPLACEMENT OF GRAVEL SURFACE COURSE SWBNO (GRAVEL)
- REMOVAL AND REPLACEMENT OF CURB (ALL TYPES)

NOTE: CONTRACTOR TO FIELD VERIFY THE LOCATION AND DIRECTION OF ALL SERVICE CONNECTIONS.

REV.	DATE	DESCRIPTION	BY
	3/19/24	Addendum 2	R.H.
SEWERAGE AND WATER BOARD OF NEW ORLEANS			
2600 S CARROLLTON			
SEWER REHABILITATION PLANS			
GENERAL SUPERINTENDENT			
DWG. NO. 8991 - S			
SCALE: NTS		SHEET NO. 29	